

Diesellová lokomotiva ČKD řady 742 (T 466.2) československé výroby.
742 (T 466.2) Czechoslovak made ČKD diesel locomotive.

Model konzultován a vytvořen ve spolupráci s Václavem Šafářem.
The kit was consulted and created in collaboration with Vaclav Safar.

rozměry modelu v mm / kit dimensions in mm

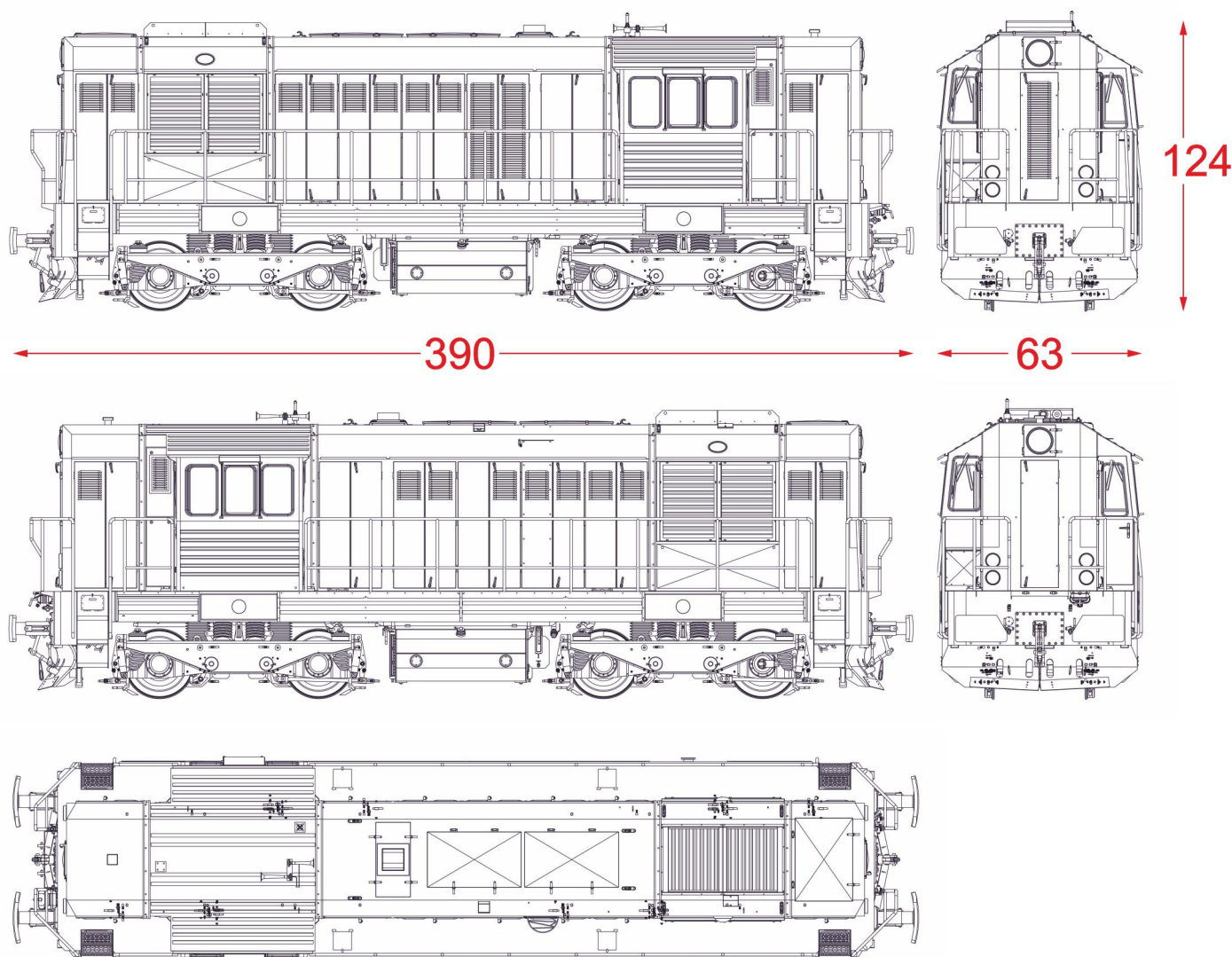

POZOR

obsahuje drobné dílky - pro modeláře od 14 let
model obsahuje díly z epoxydové pryskyřice která může při opracování dráždit oči, kůži a dýchací systém
při opracovávání a manipulaci s dílky používejte ochranných pomůcek, vyvarujte se jejich vdechnutí

ATTENTION

contains small parts - for modellers from 14 years
model contains parts from epoxy resin which can irritate the eyes, skin and breathing system during the working
please use the protective aids during manipulation and cutting, avoid of their breathing

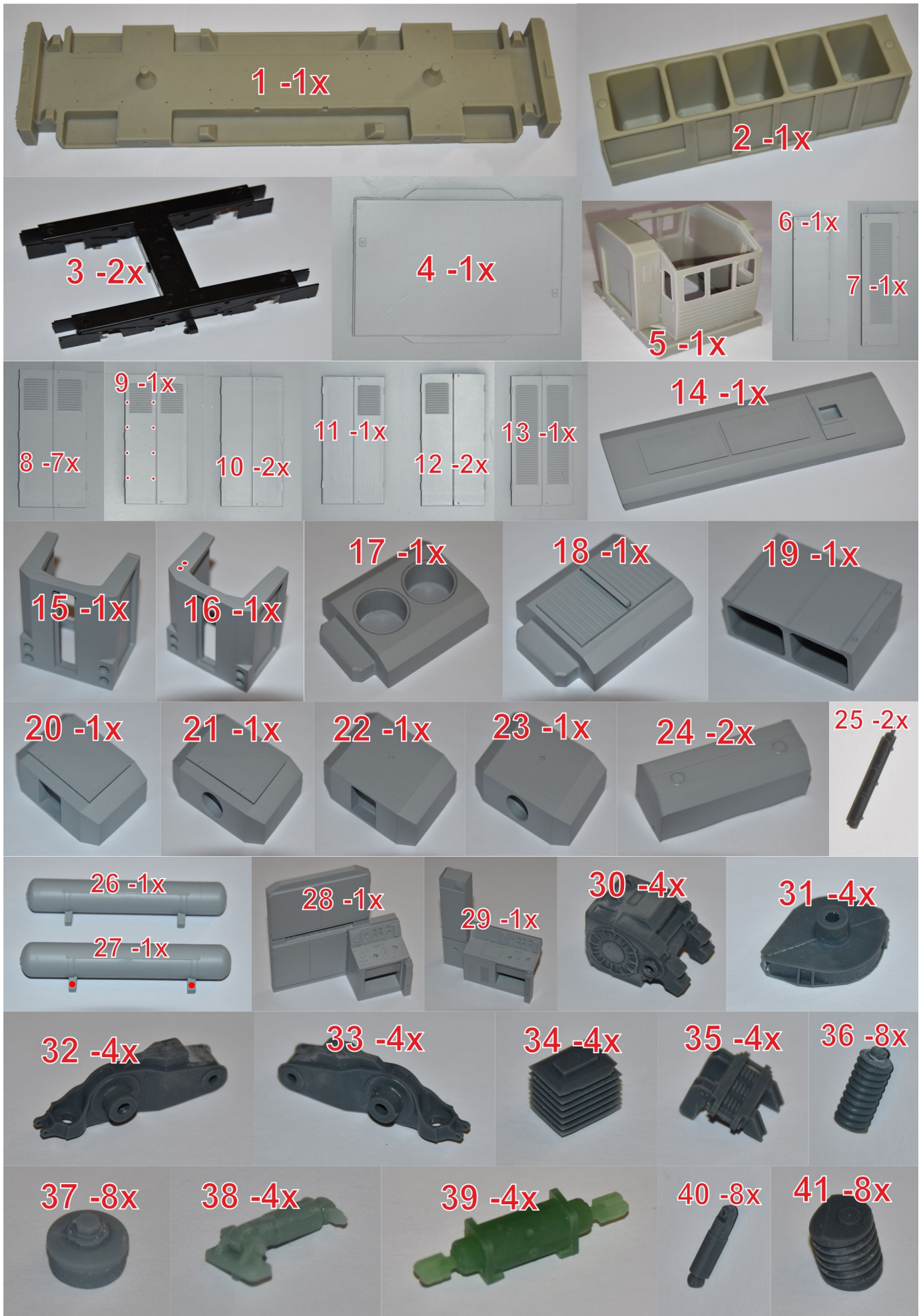

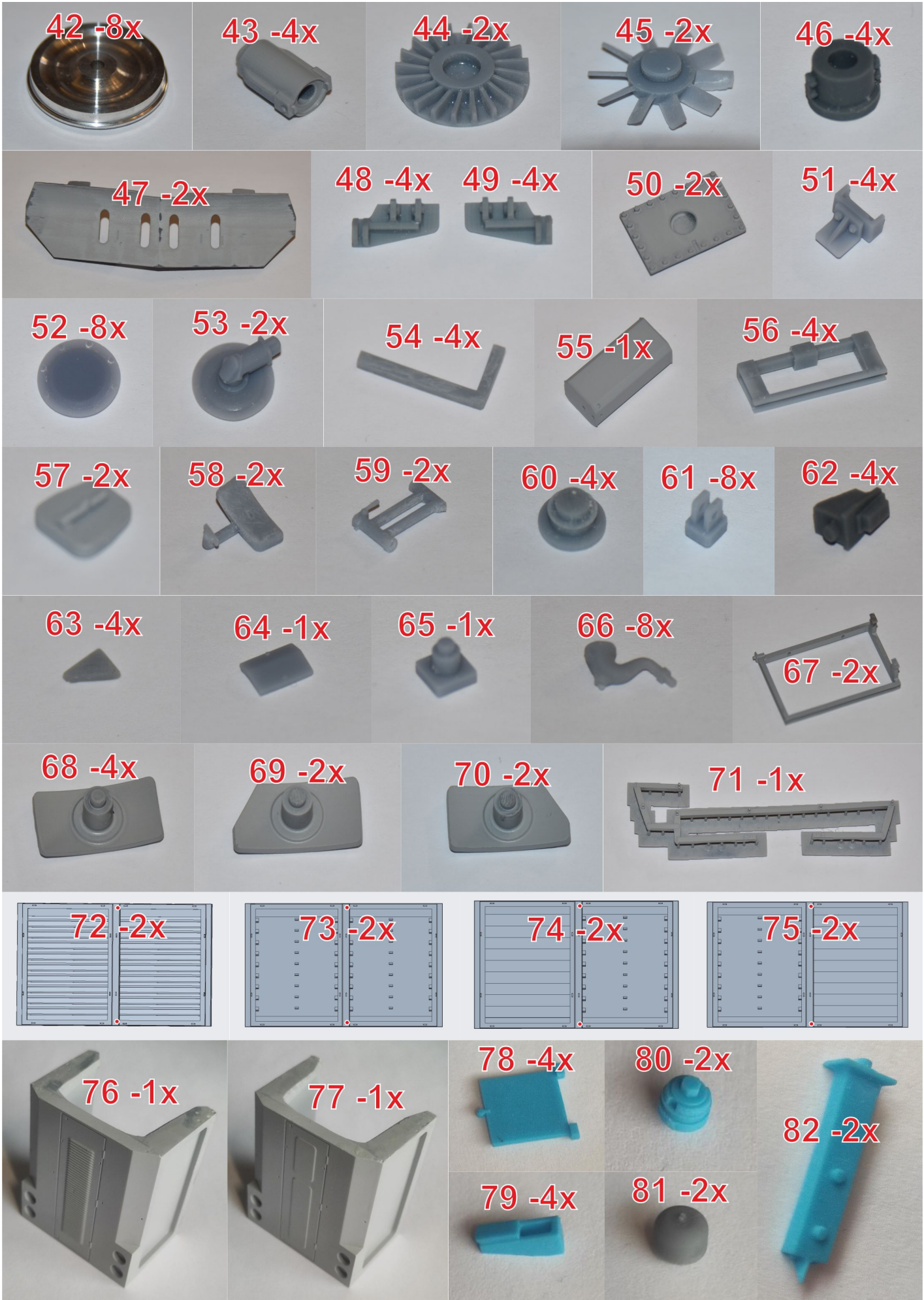

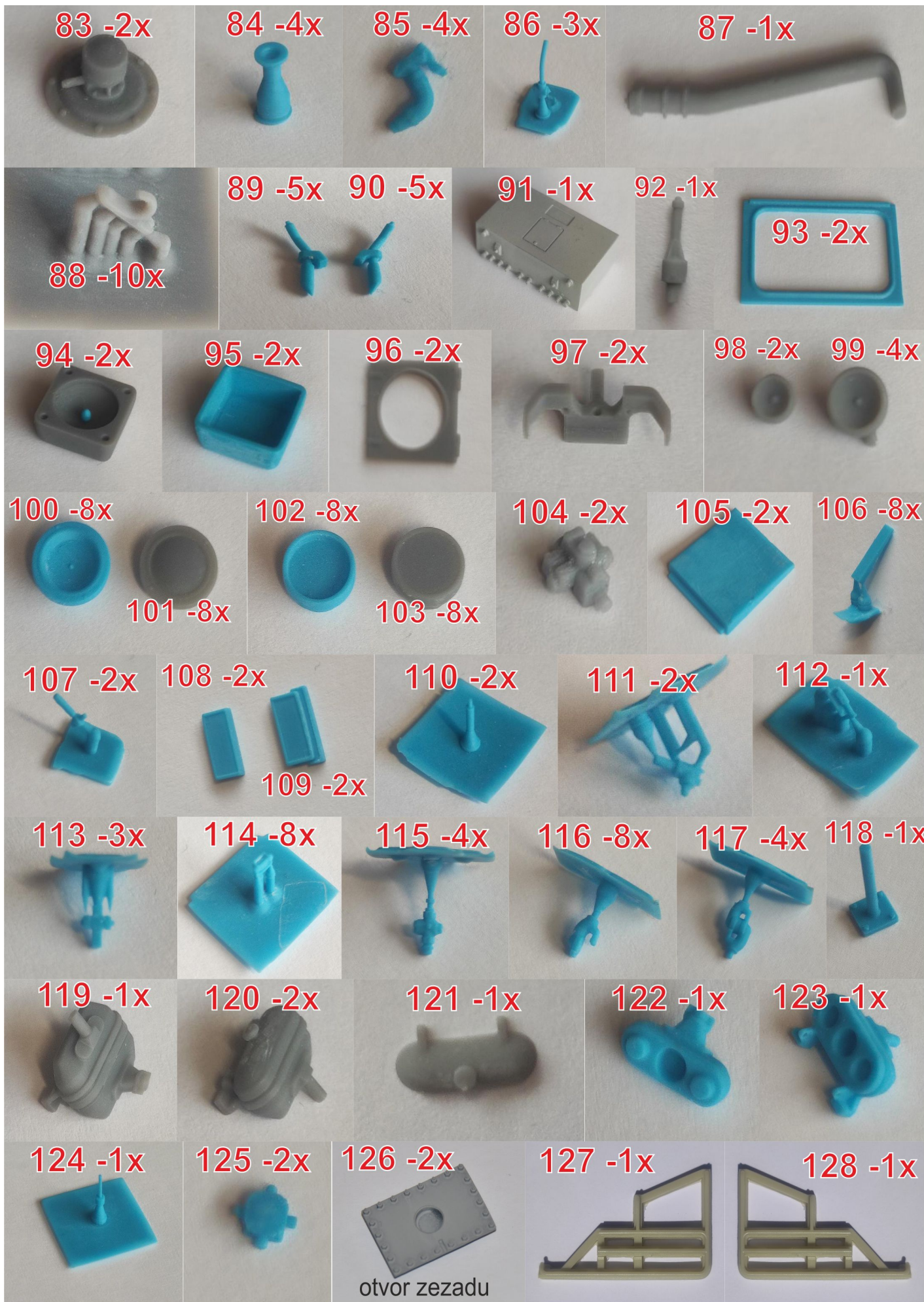

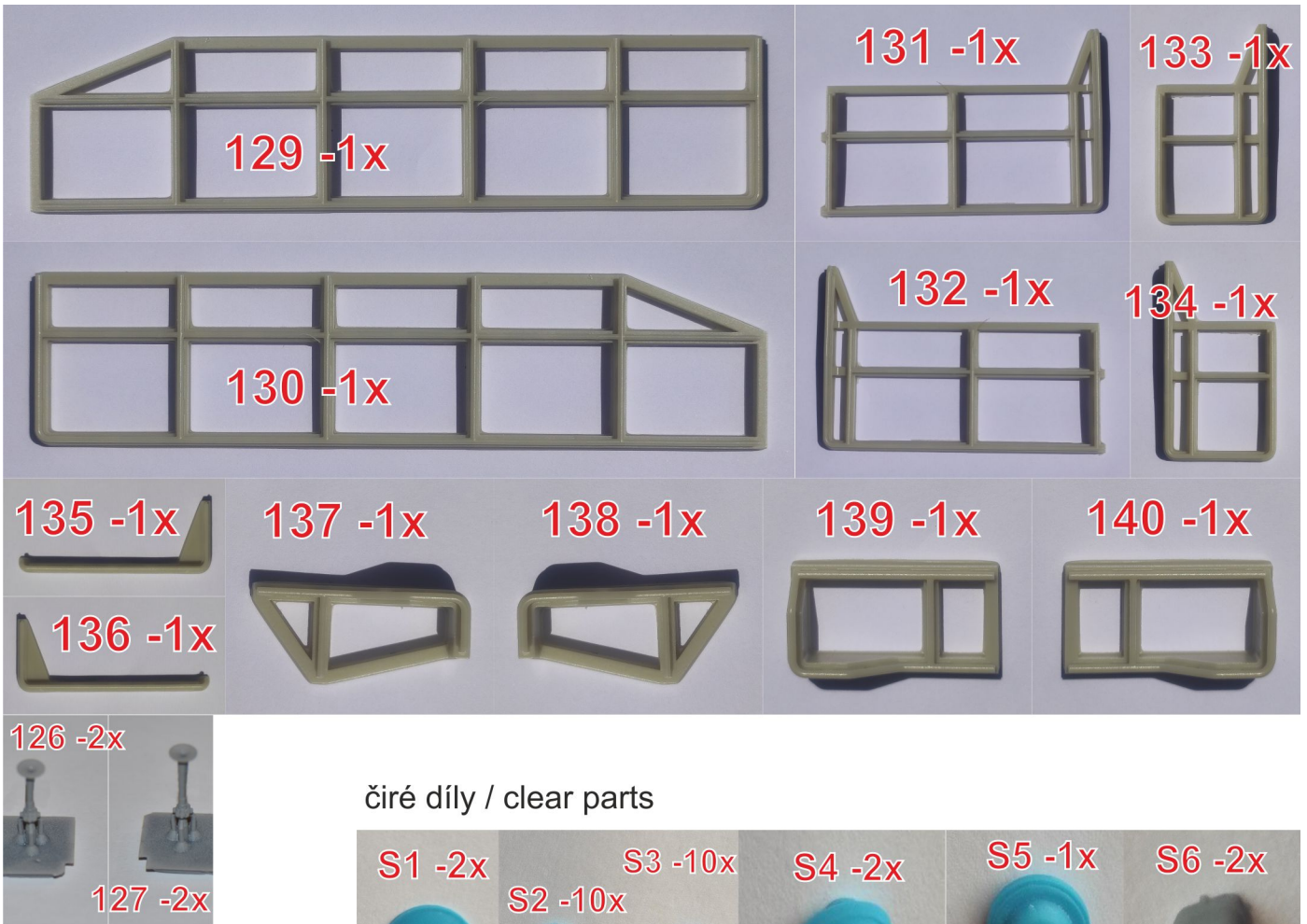

čiré díly / clear parts

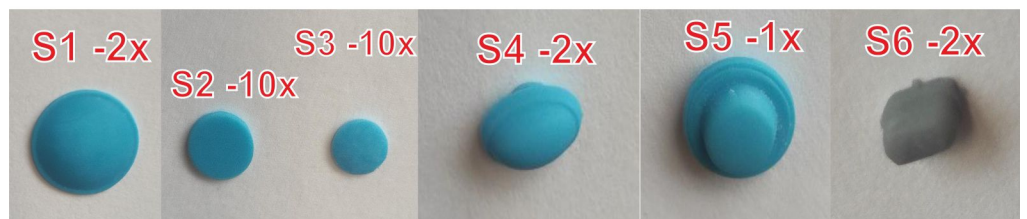

3D tištěné díly / 3D printed parts



hliníkový čep / aluminium pin

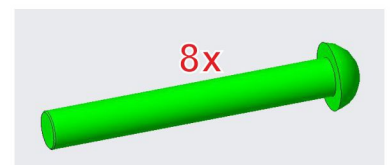

fotoleptané díly / photoetched parts

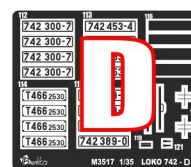
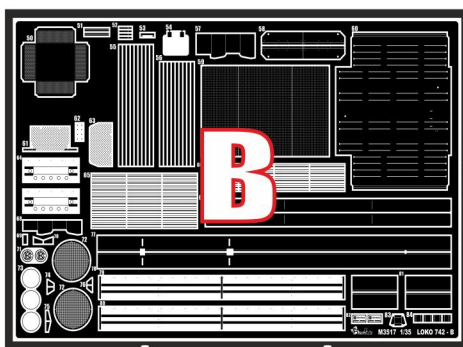
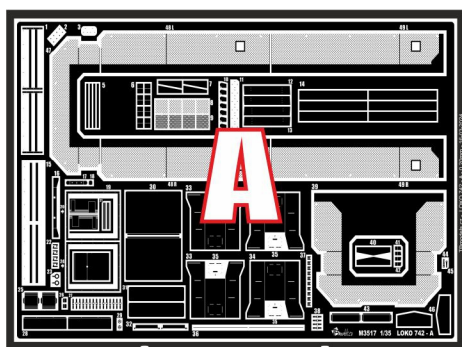

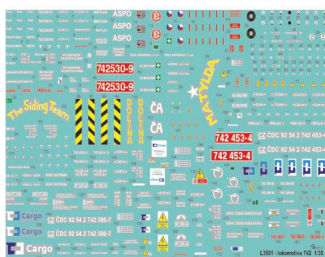

obtisky / decal sheets



další doplňky v této krabici other accessories in this box:

- silikonová hadička / silicone tube 1,2mm - 30cm
- silikonová hadička / silicone tube 1,9mm - 25cm
- drát / wire 0,4mm - 3cm
- drát / wire 0,6mm - 60cm
- drát / wire 1mm - 10cm
- 1x čirá folie / clear sheet styrene
- vytištěný návod / printed manual

Návod pro práci s obtisky / instructions for working with decals

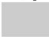
- 1.)  Obtisky s ochranným lakem  pouze na samostatném obtisku
Decals with protective varnish  only on a separate decal

- každý obtisk vystříhnout 1-2mm od potisku (za tuto oblast lze uchytit pinzetou)
- na několik vteřin namočit do teplé vody až se papír provlhčí tak, že se dá s obtiskem po papíru pohybovat
- přenesete na správné místo na modelu a štětečkem stáhnete z papíru
- odsát a vytlačit z pod obtisku zbylou vodu

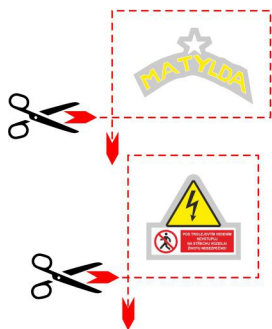

- cut each decal 1-2mm from the print (you can grab this area with tweezers)
- soak in warm water for a few seconds until the paper is wet so that you can move the decal on the paper
- transfer it to the right place on the model and use a brush to remove it from the paper
- suck and squeeze out the remaining water from the decal

- 2.)  Obtisky s ochranným lakem  na celé ploše papíru
Decals with protective varnish  on the entire surface of the paper

- každý obtisk je nutno vystříhnout co nejlíže k potisku
- na několik vteřin namočit do teplé vody až se papír provlhčí tak, že se dá s obtiskem po papíru pohybovat
- přenesete na správné místo na modelu a štětečkem stáhnete z papíru
- odsát a vytlačit z pod obtisku zbylou vodu

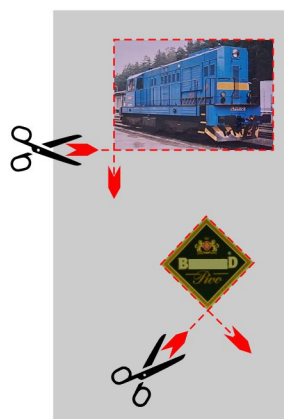

- each decal must be cut out as close to the print as possible
- soak in warm water for a few seconds until the paper is wet so that you can move the decal on the paper
- transfer it to the right place on the model and use a brush to remove it from the paper
- suck and squeeze out the remaining water from the decal

NÁVOD KE STAVBĚ MODELU / ASSEMBLY MANUAL

tuto stranu vyrobit 2x / this page make 2x

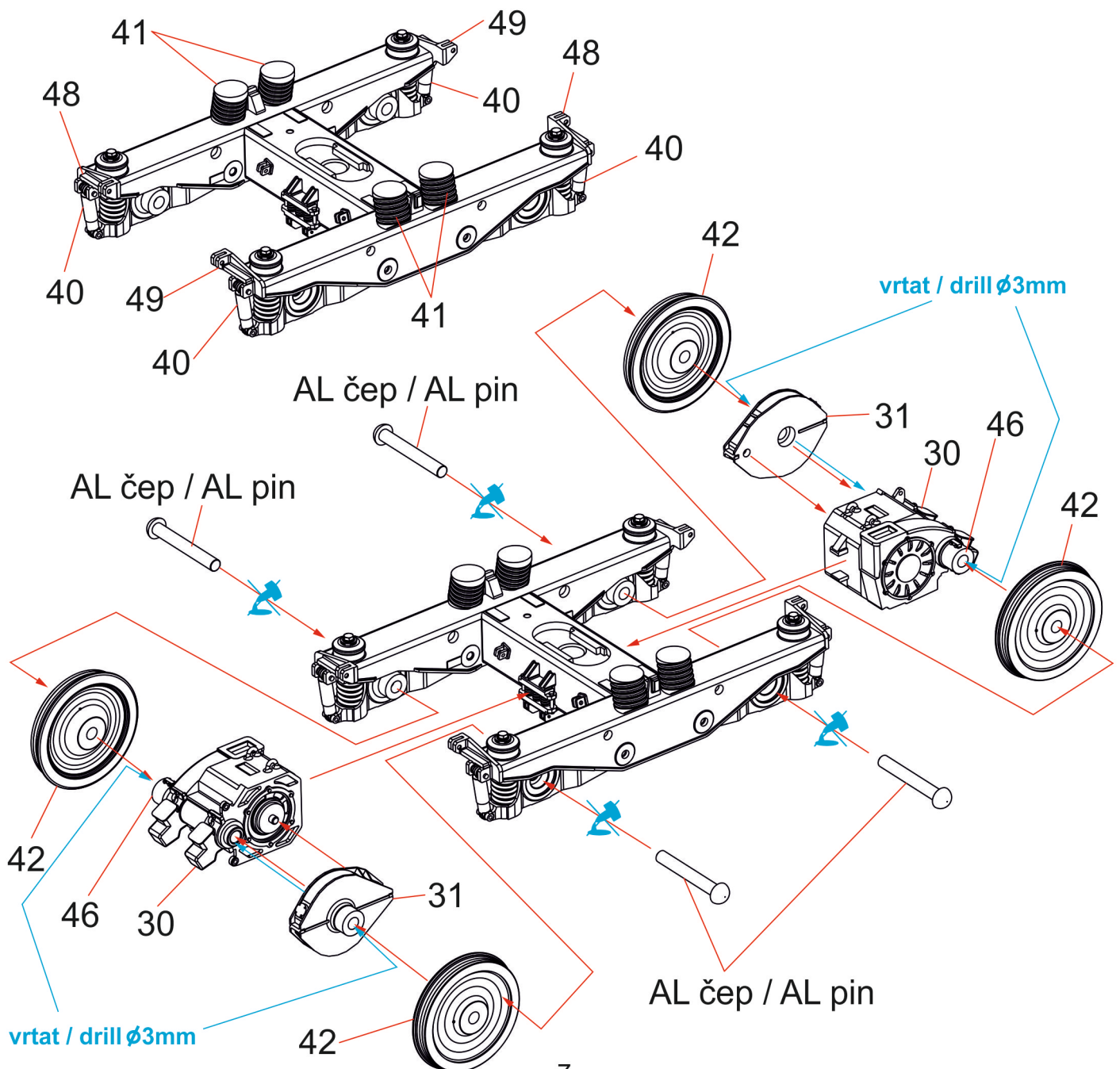
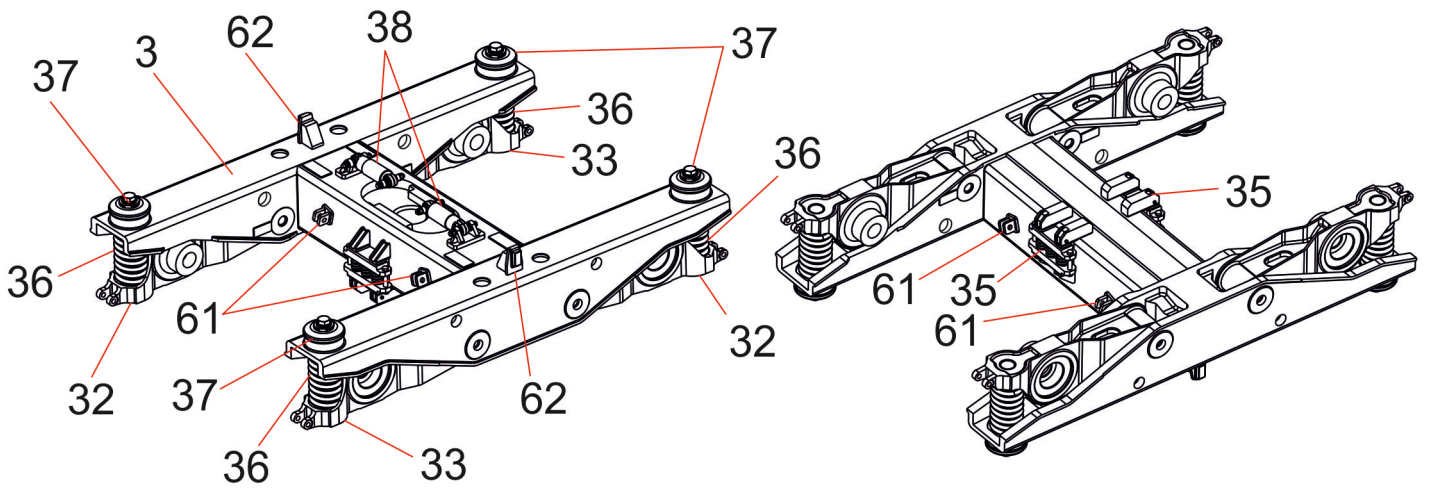

podvozek 1 - bez ruční brzdy / chassis 1 - without hand brake

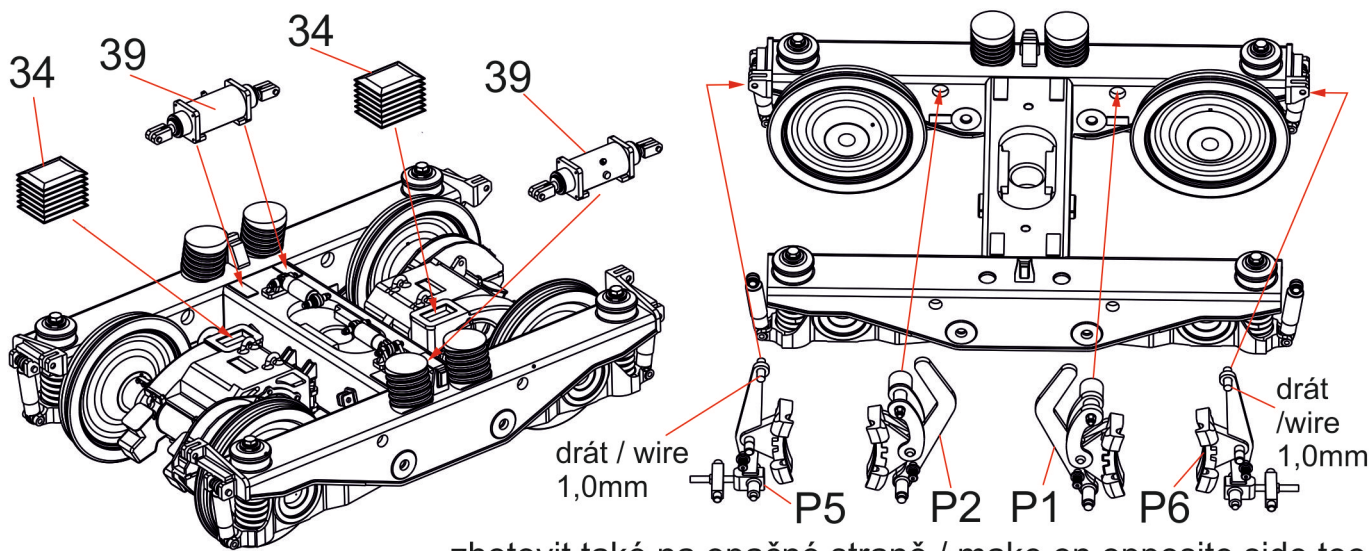

zhotovit také na opačné straně / make on opposite side too

podvozek 2 - s ruční brzdou / chassis 2 - with hand brake

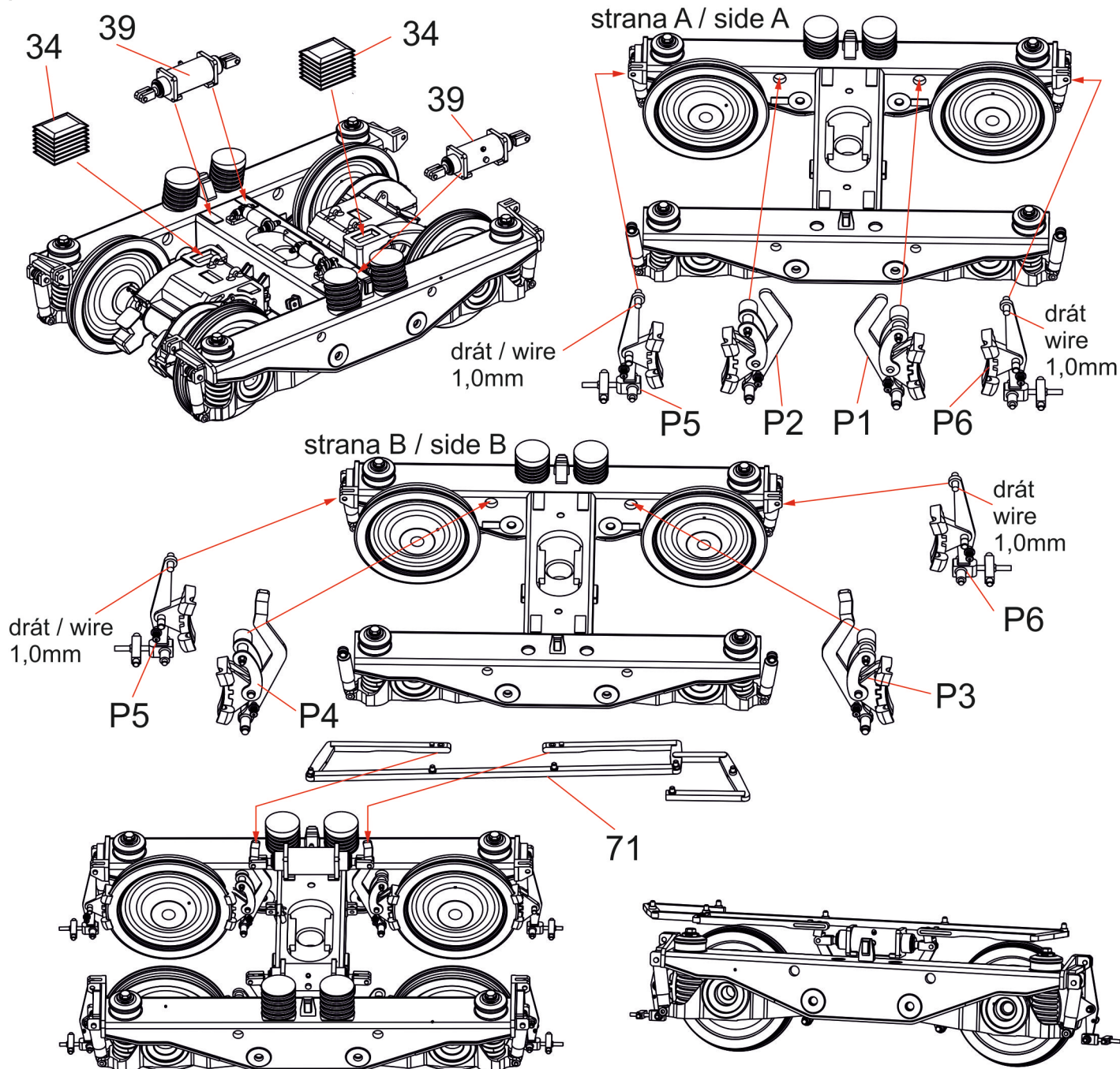

podvozek 1 - bez ruční brzdy
chassis 1 - without hand brake

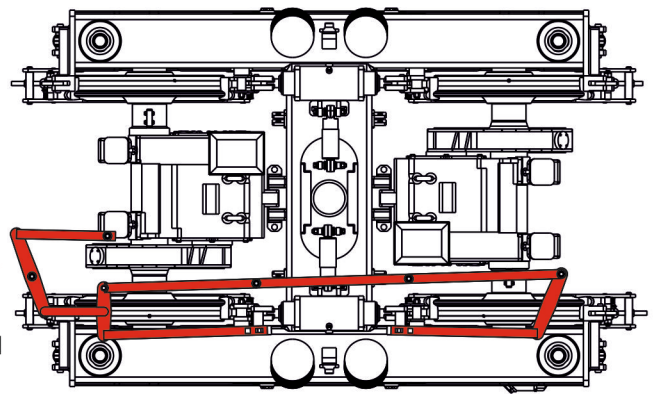
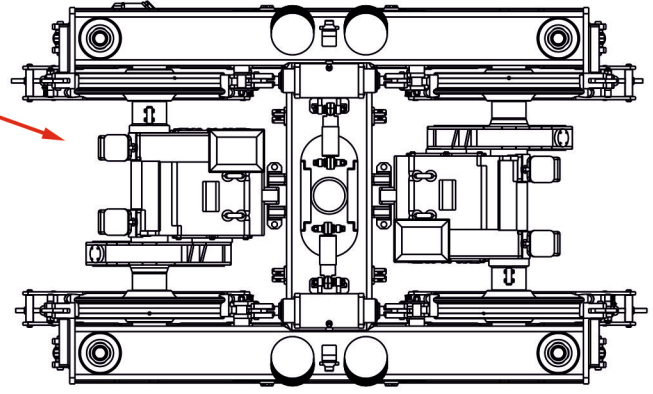
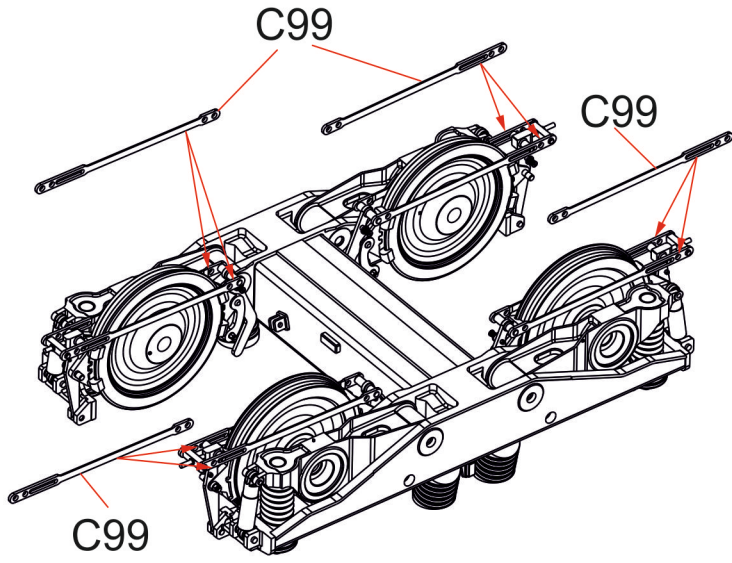

podvozek 2 - s ruční brzdou
chassis 2 - with hand brake

podvozek 1 - bez ruční brzdy / chassis 1 - without hand brake

? verze / optional

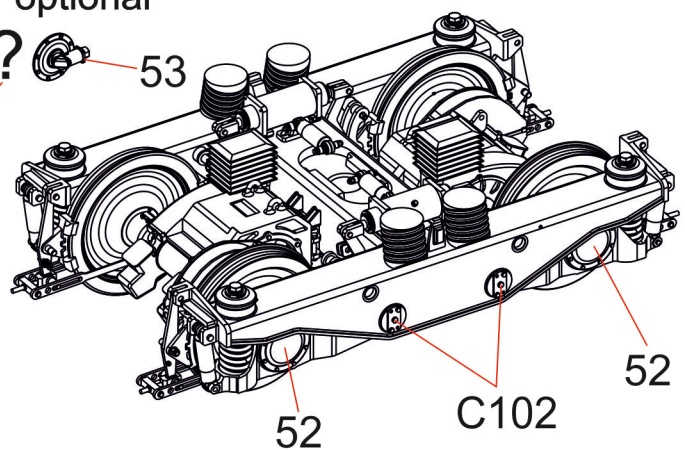
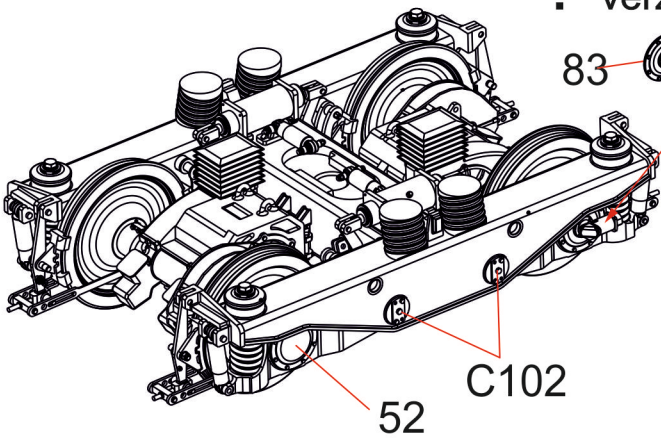

podvozek 2 - s ruční brzdou / chassis 2 - with hand brake

? verze / optional

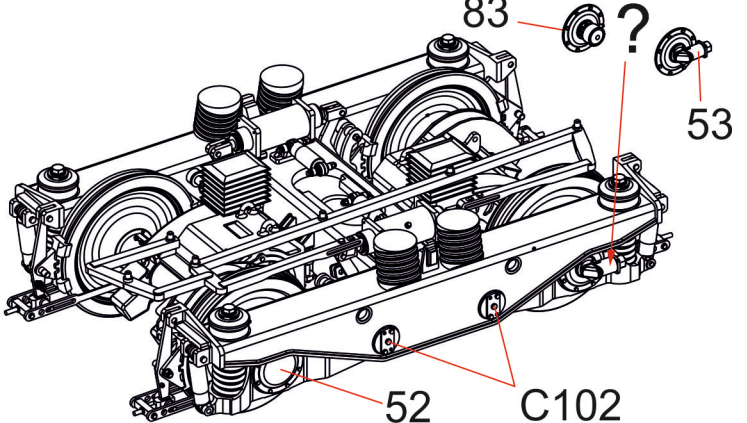
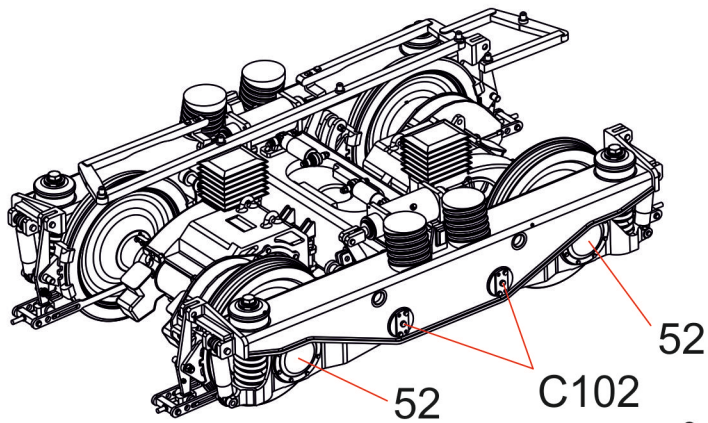

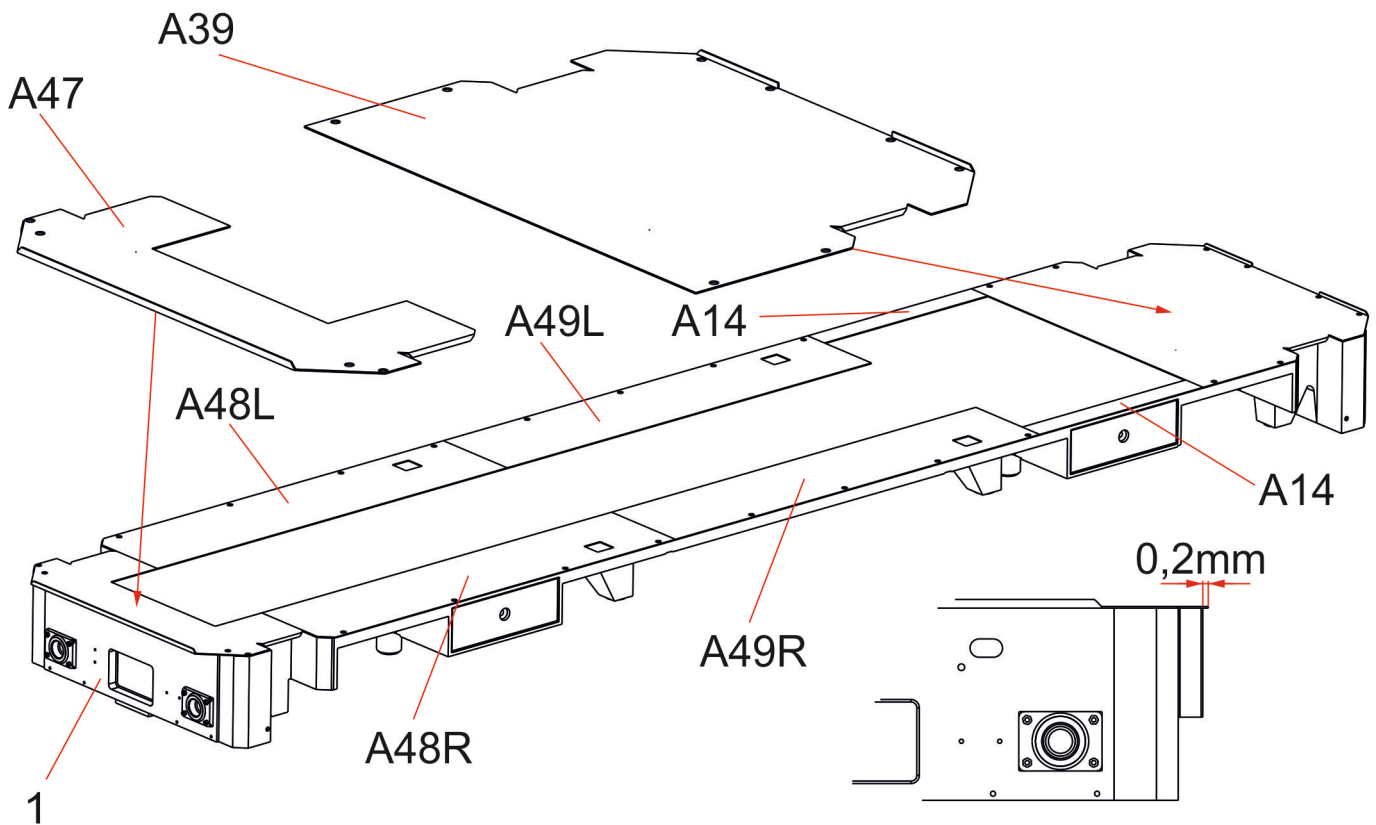
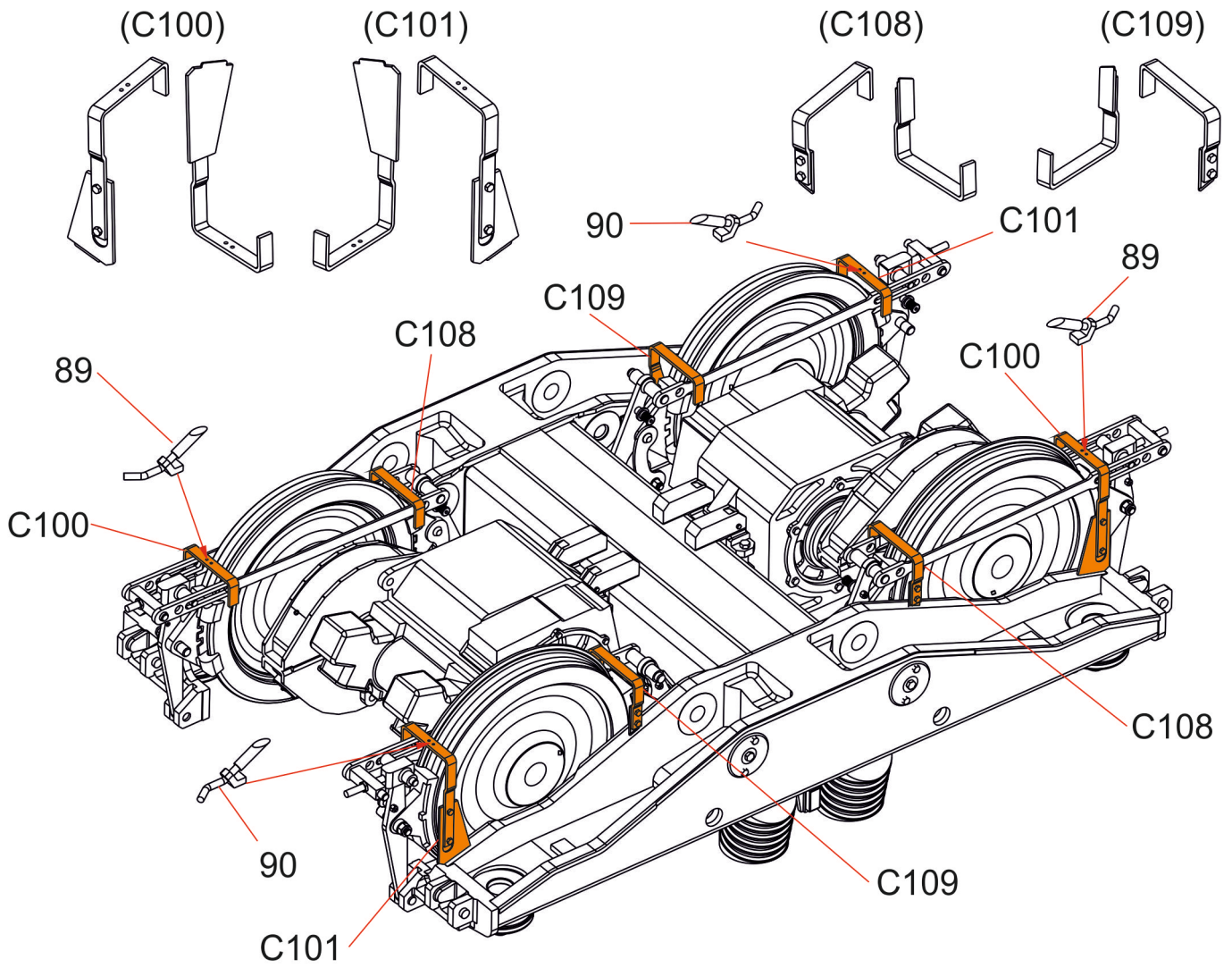

z obou stran
make on both sides

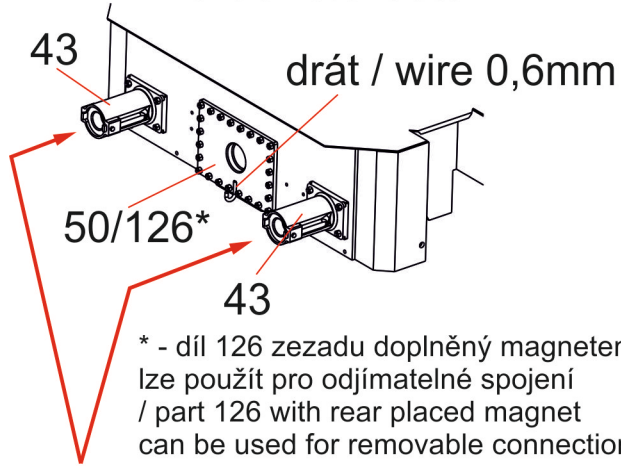

orientace doleva
orientation to the left

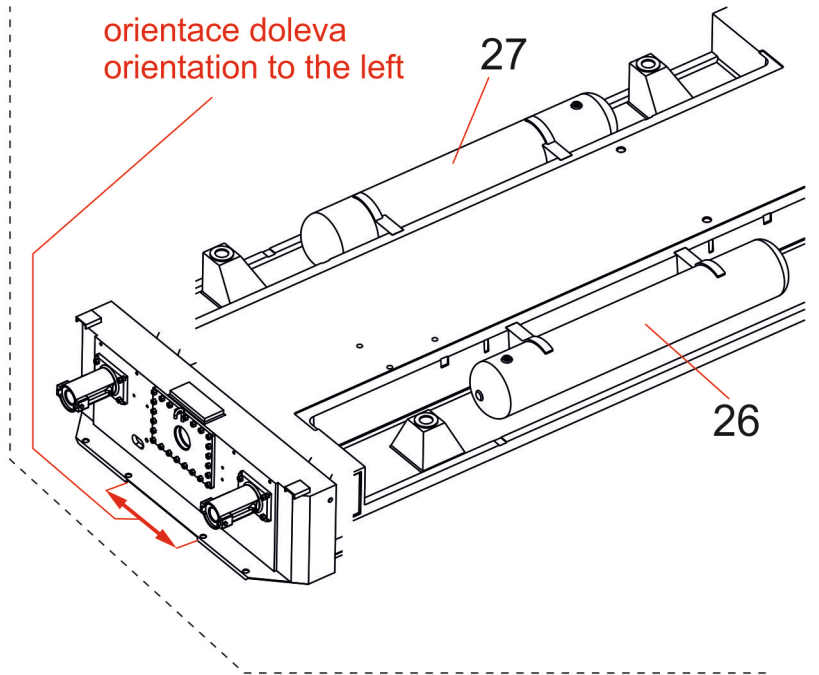

? verze / optional

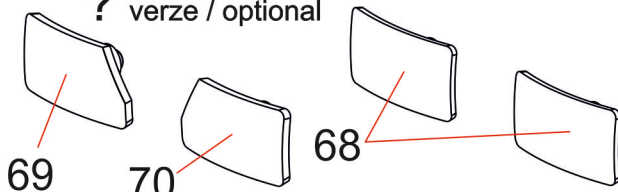

nádrž 1 / tank 1

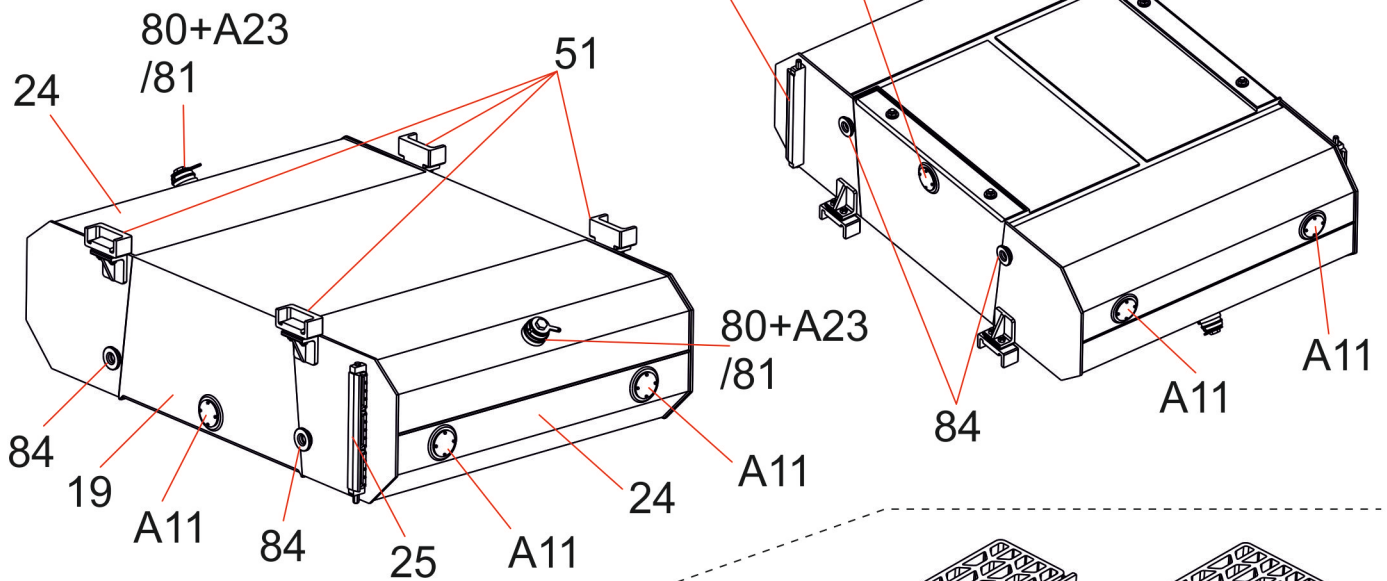

nádrž 2 / tank 2

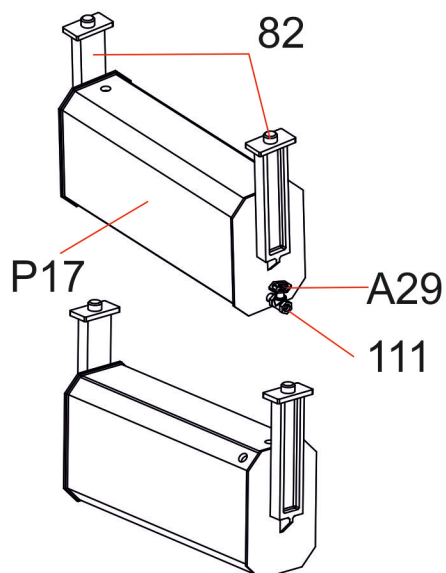

schody / stairs
vyrobit 2x / make 2x

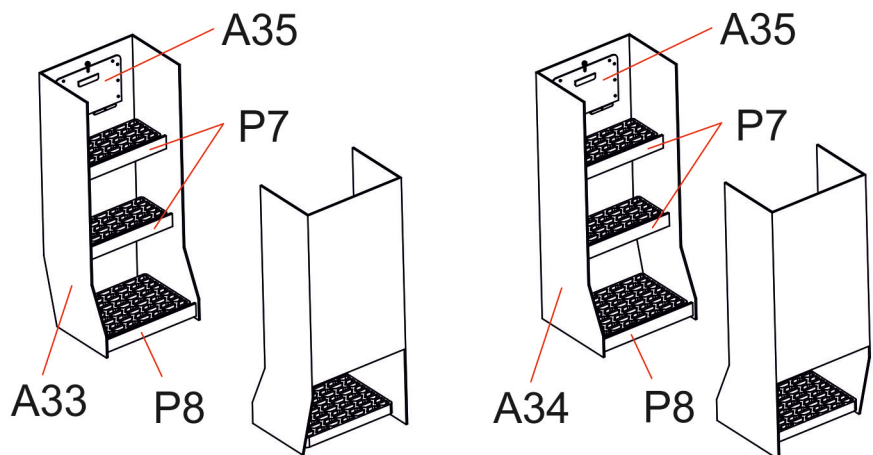

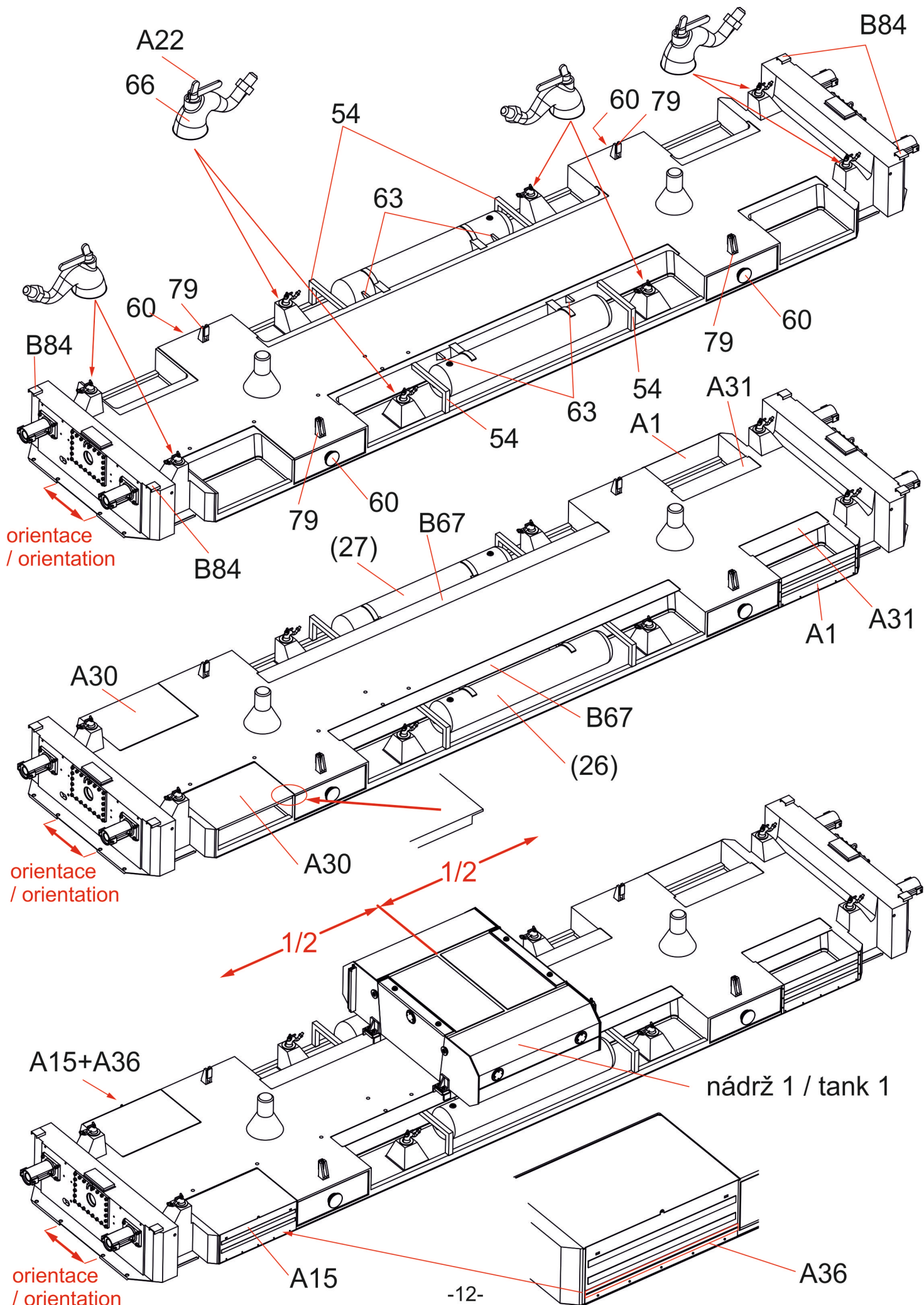

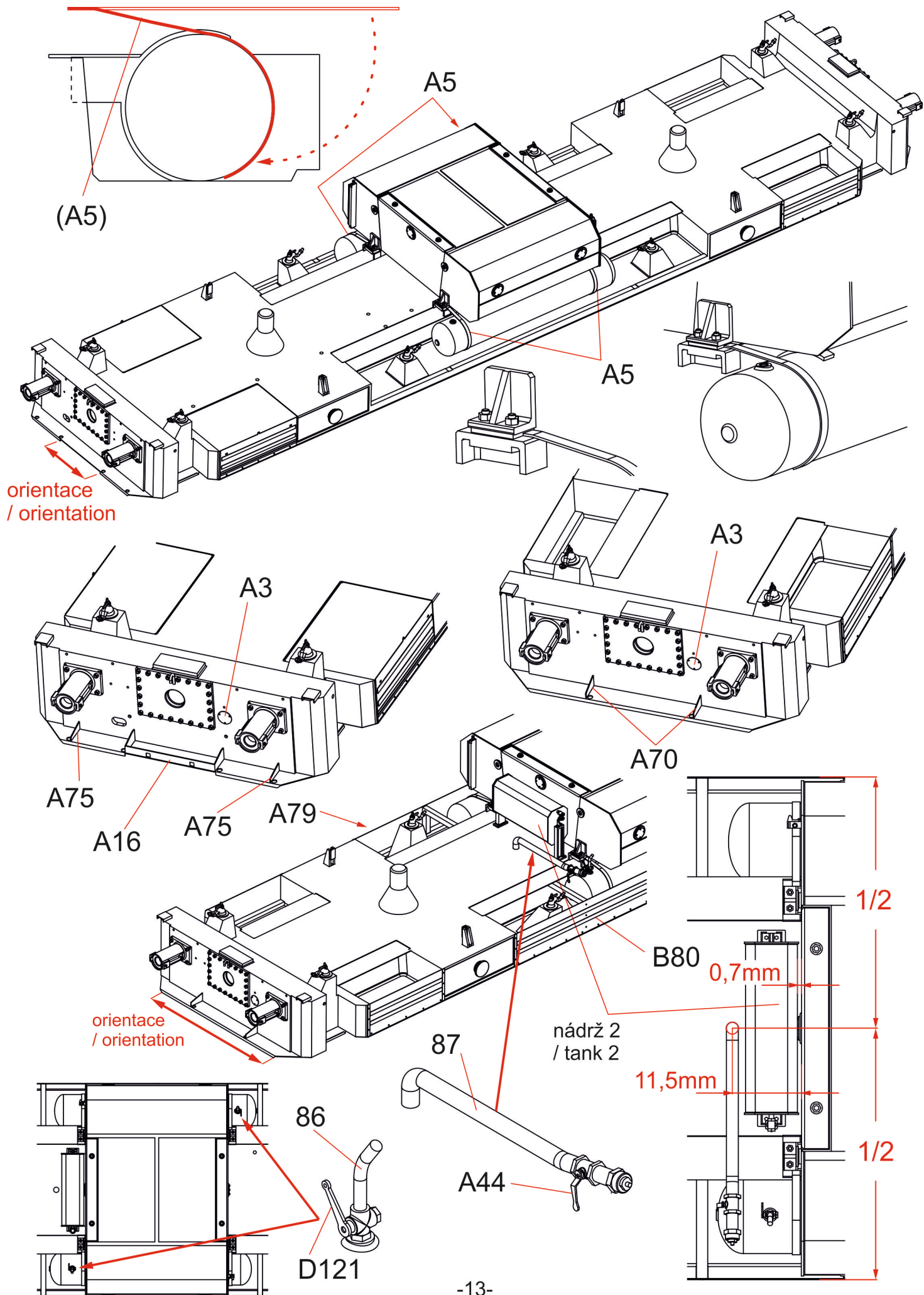

pluh / plow

vyrobiť 2x / make 2x

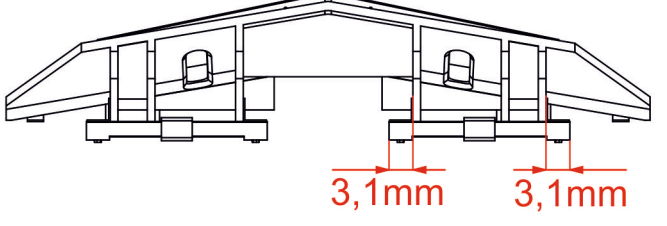
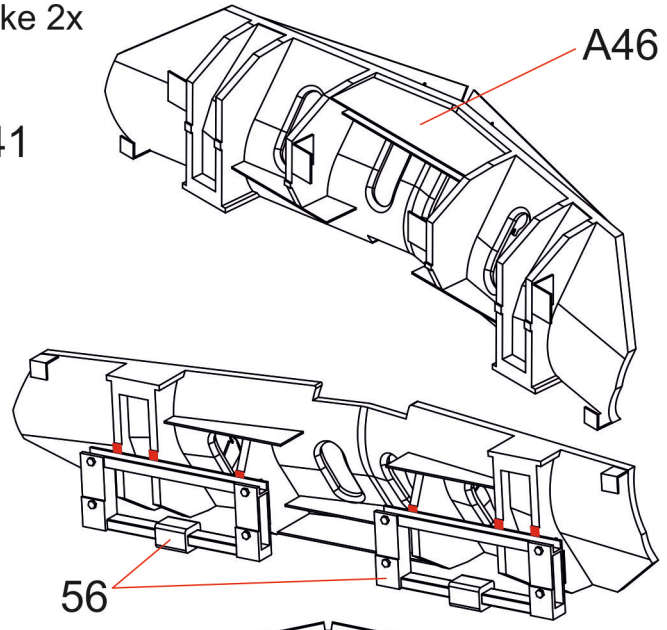
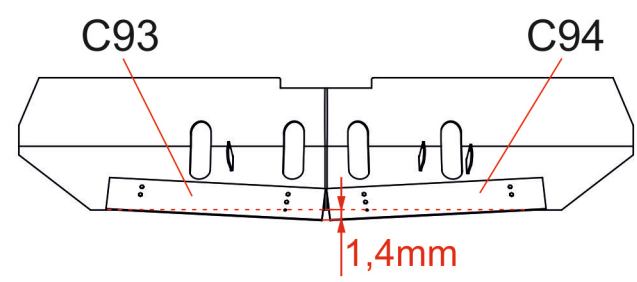
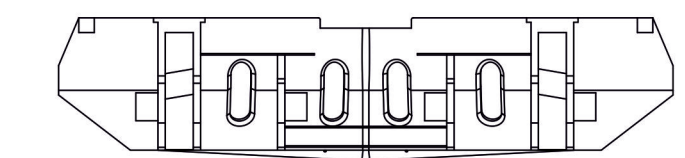
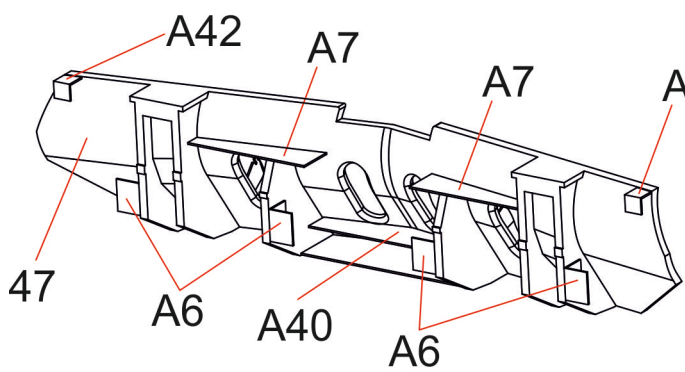

pouze na jedné straně 742 530 / only on one side of 742 530

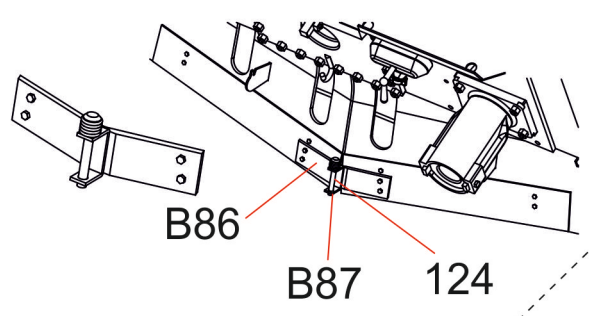

schody / stairs

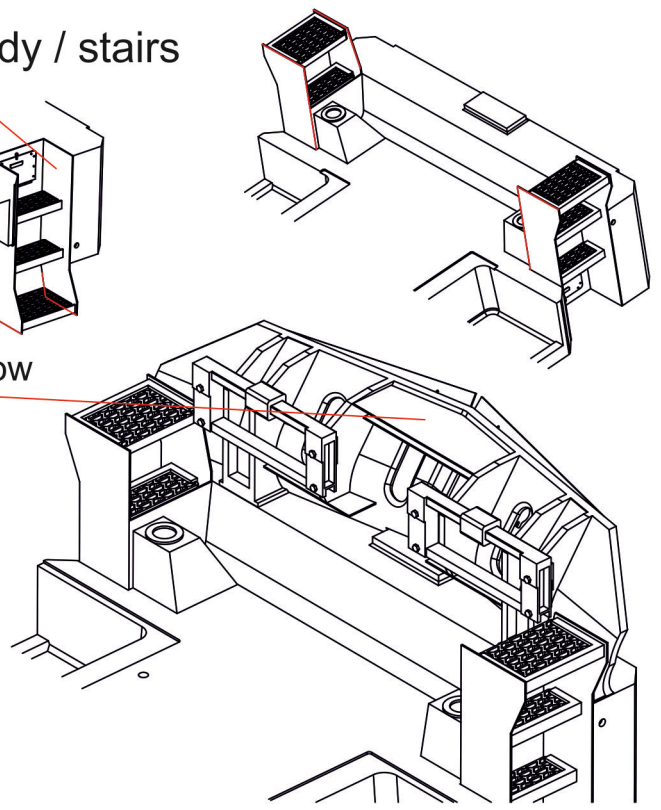
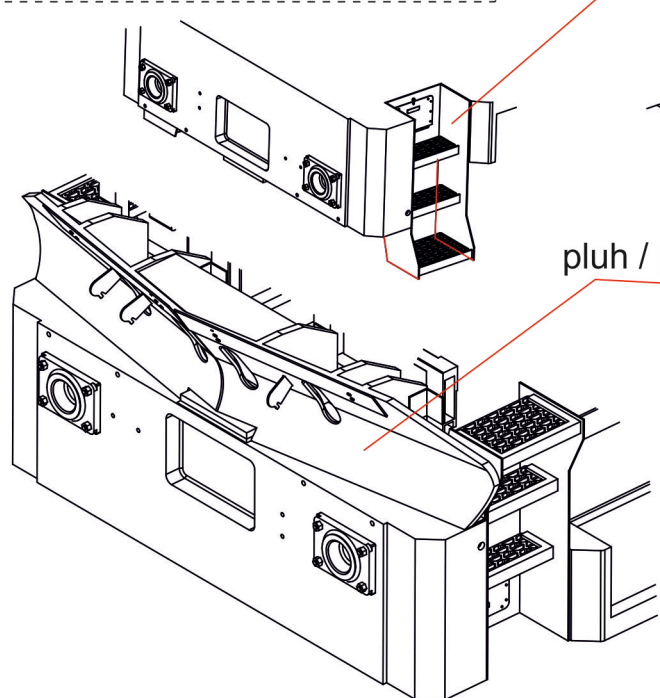
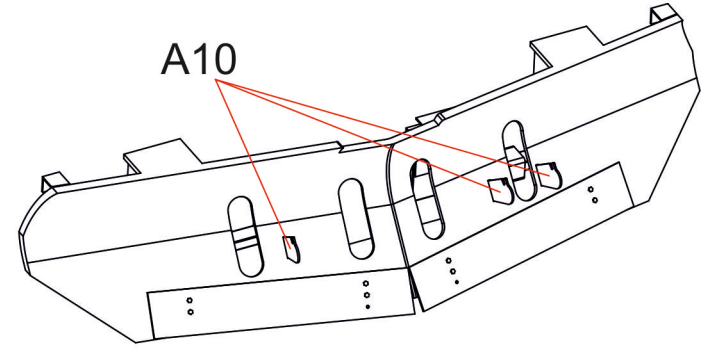

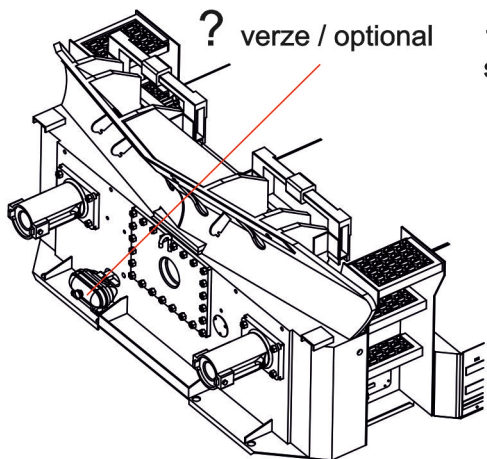

1.) samostatná lokomotiva
single locomotive

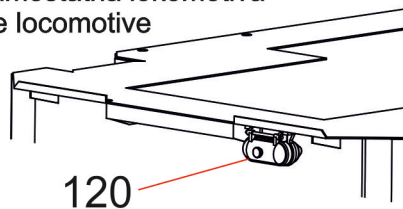

120

2.) pevné spojení dvou lokomotiv
fixed connection of two locomotives

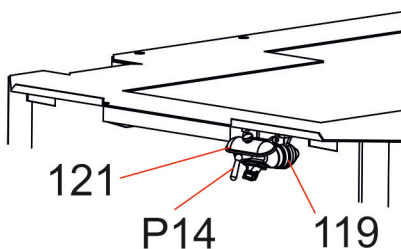

121

P14

119

3.) odpojitelné spojení
dvou lokomotiv magnety
detachable connection
of two locomotives by magnets

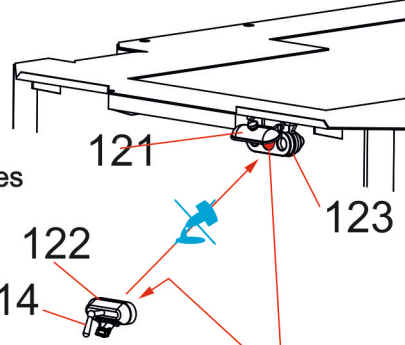

121

122

123

P14

magnety (pozor na polaritu)
magnets (watch the polarity)

skříň 1 / box 1

vyrobiť 1x - nabarvit a osadiť obtisky / make 1x - paint and apply decals

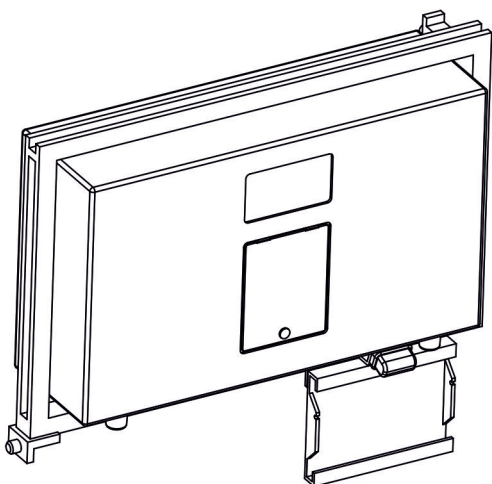

67

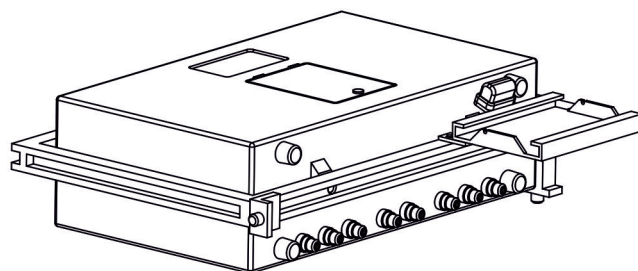

91

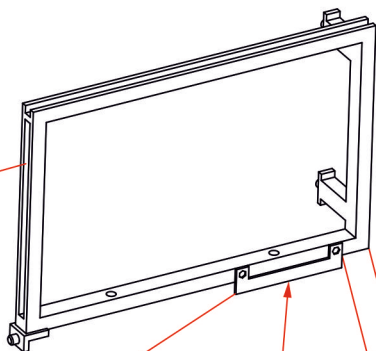

2,3mm

B53

A26

P13

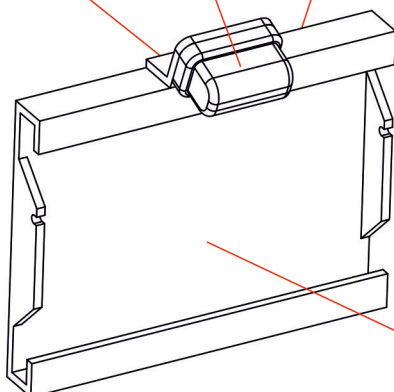

A25

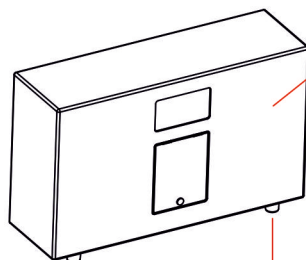

nabarvit a osadit obtisky / paint and apply decals

panel 1 / panel 1

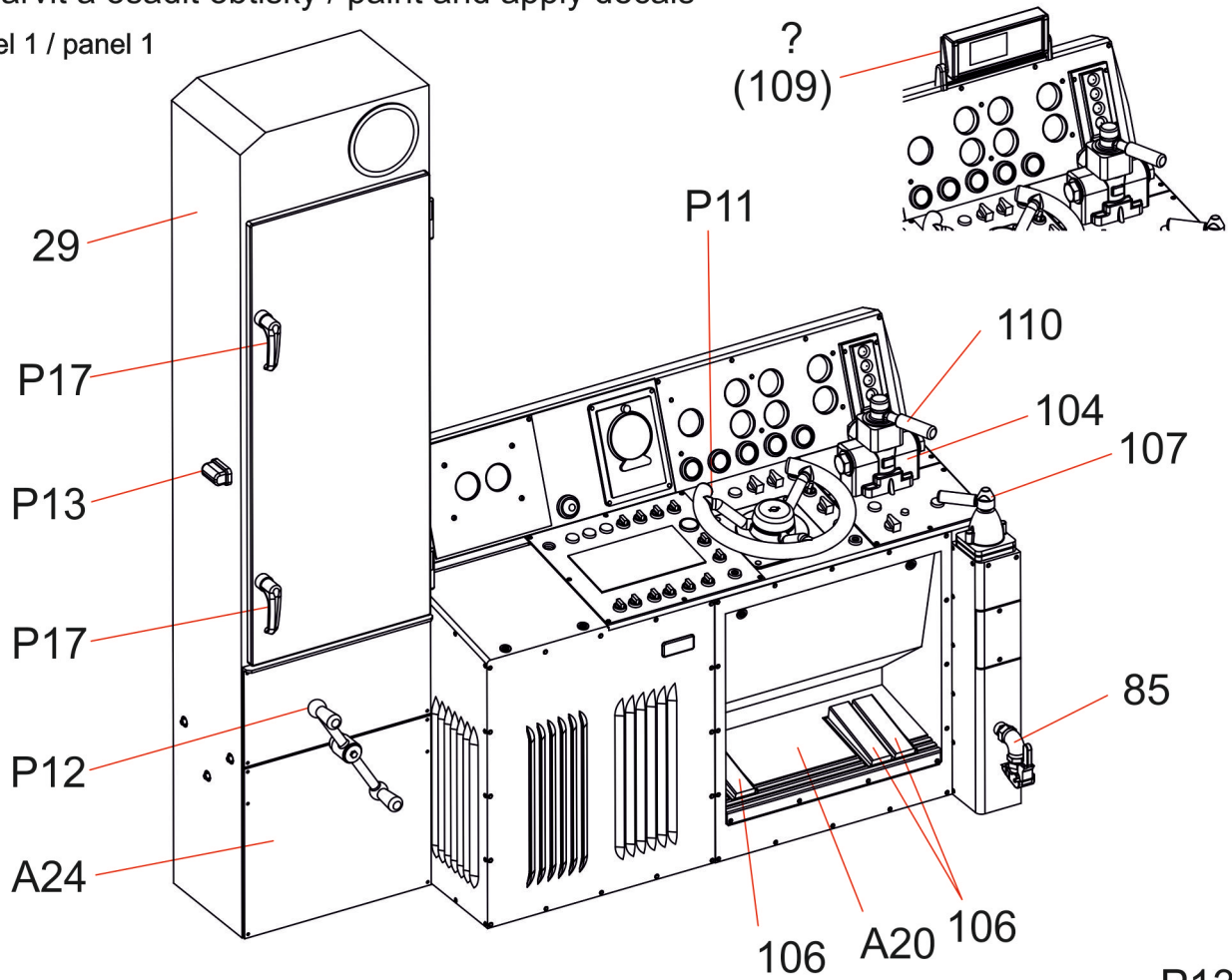

panel 2 / panel 2

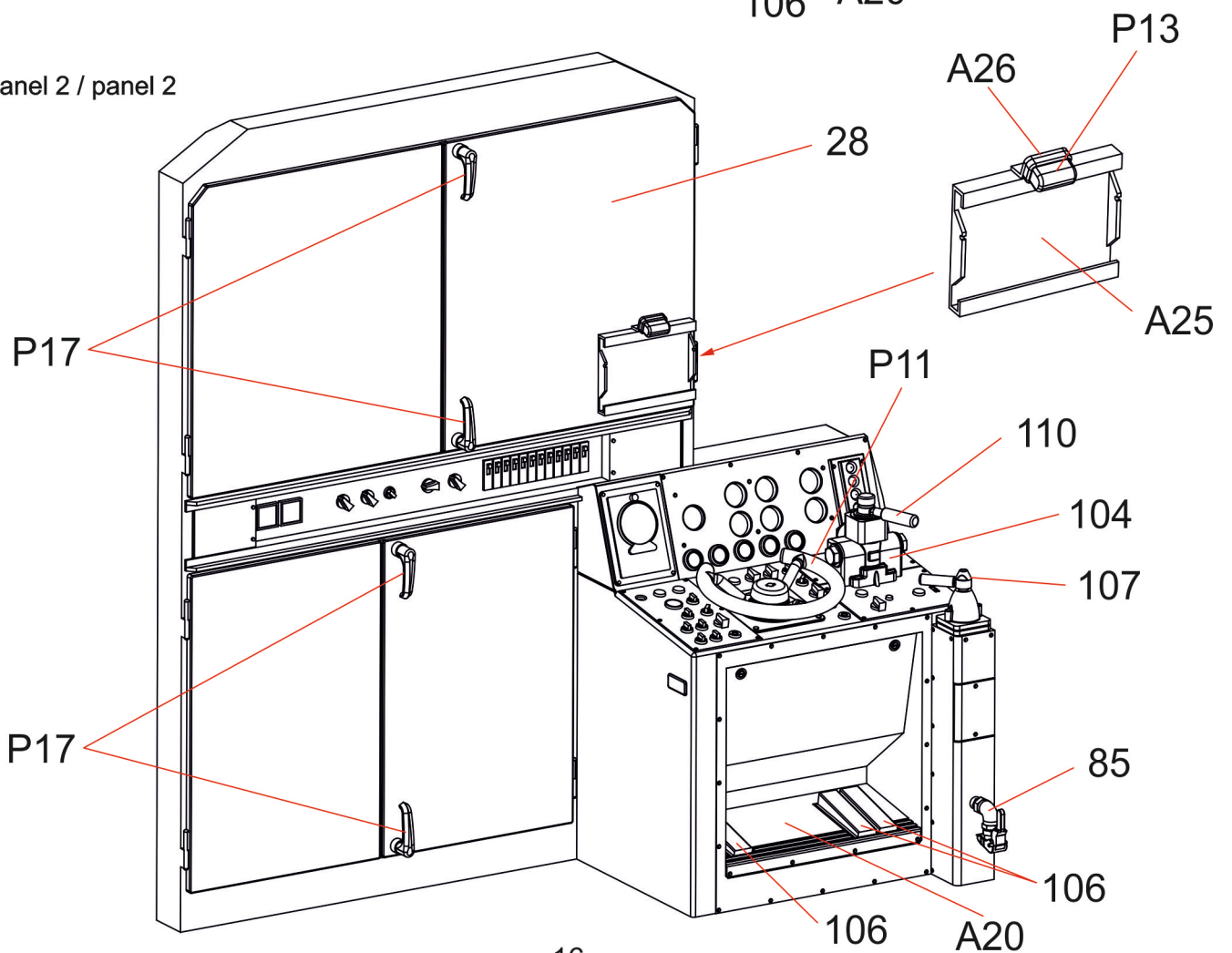

nabarvit interiér / paint the interior

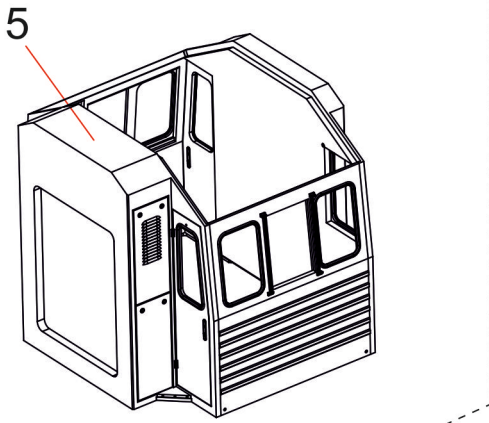

5

z obou stran / make on both sides

? verze / optional

zavřené okno / closed window

otevřené okno / opened window

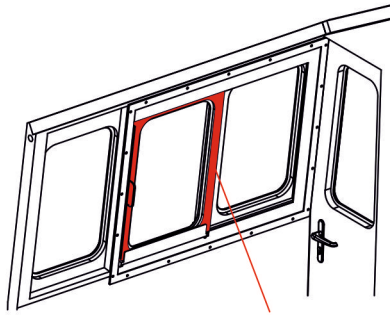

(93)

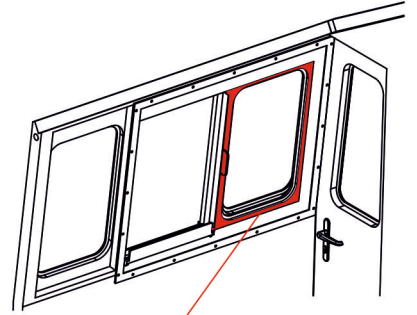

(93)

díly nabarvit z obou stran před vlepáním / paint the parts on both sides before gluing

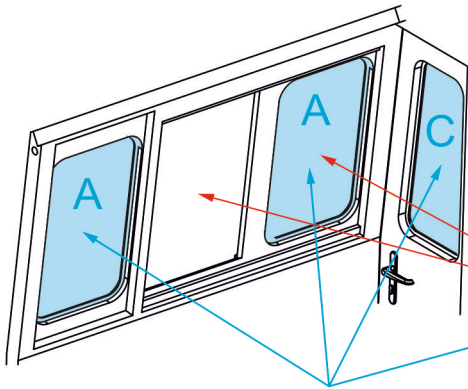

vlepit okna / place windows

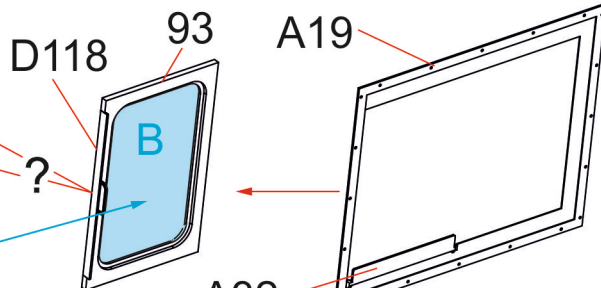

A32

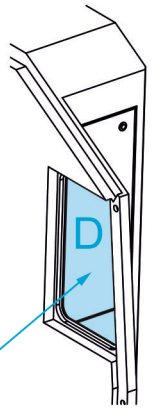

vlepit okna / place windows

4

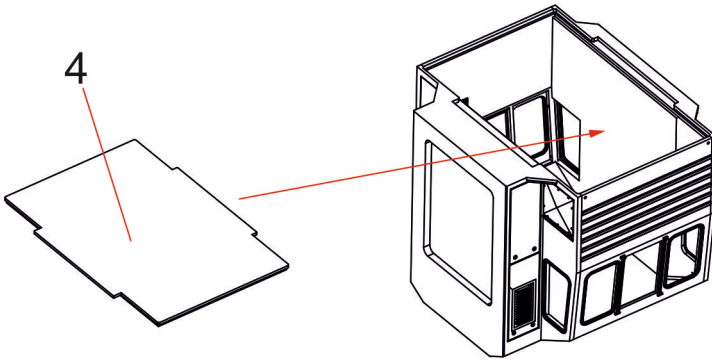

panel 1 + skříň 1 / panel 1 + box 1

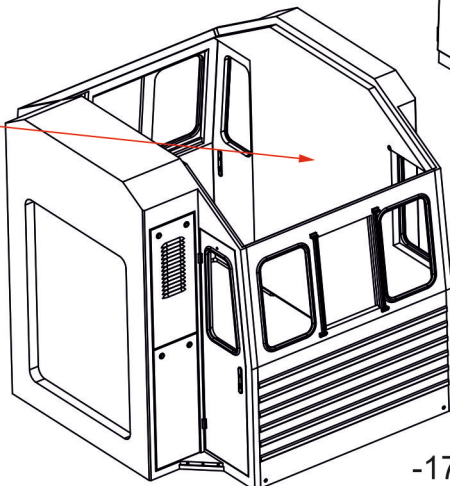
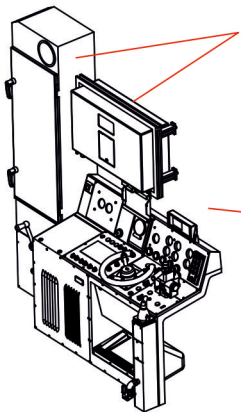

panel 2 / panel 2

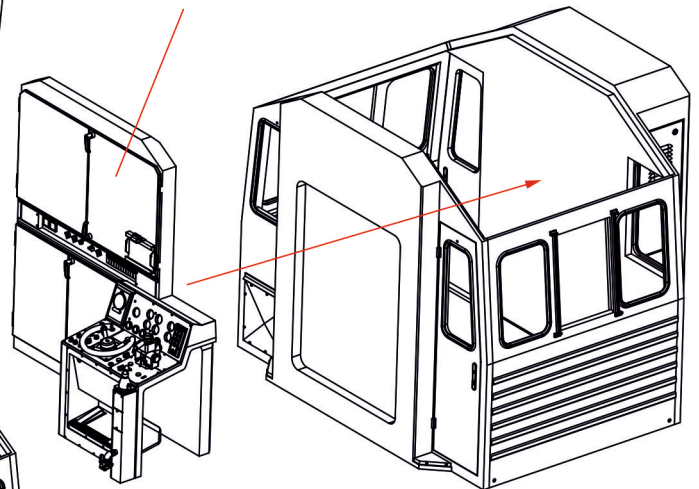

? verze / optional

pouze na jedné straně
/ only one side

z obou stran / make on both sides

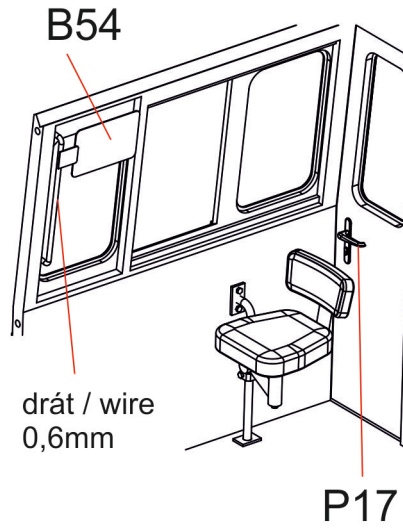
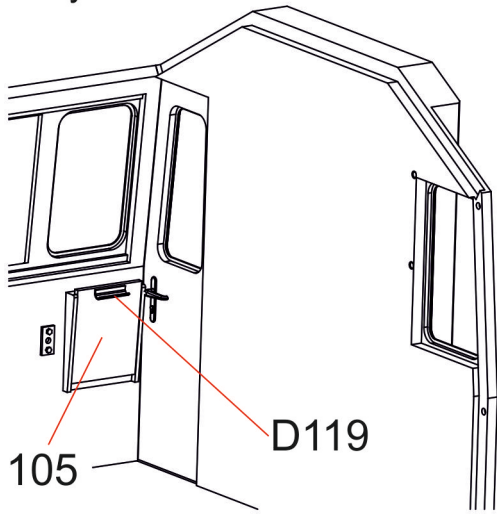

drát / wire
0,6mm

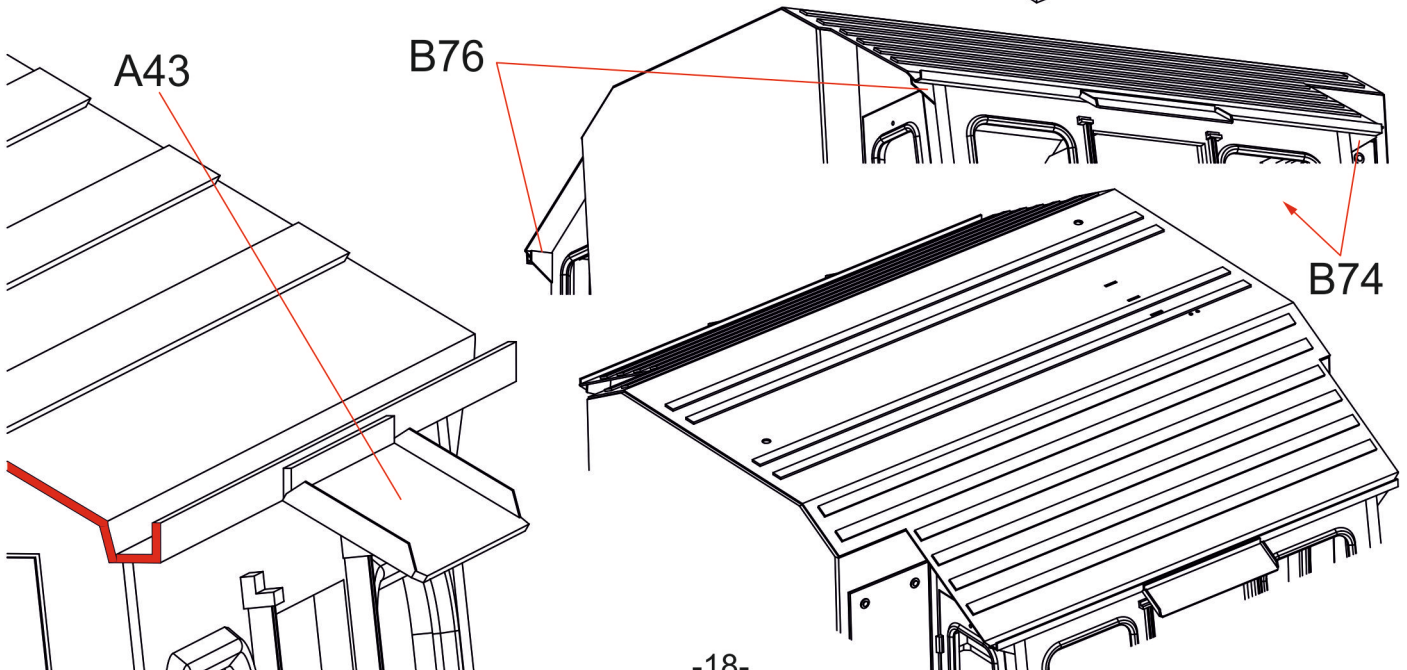
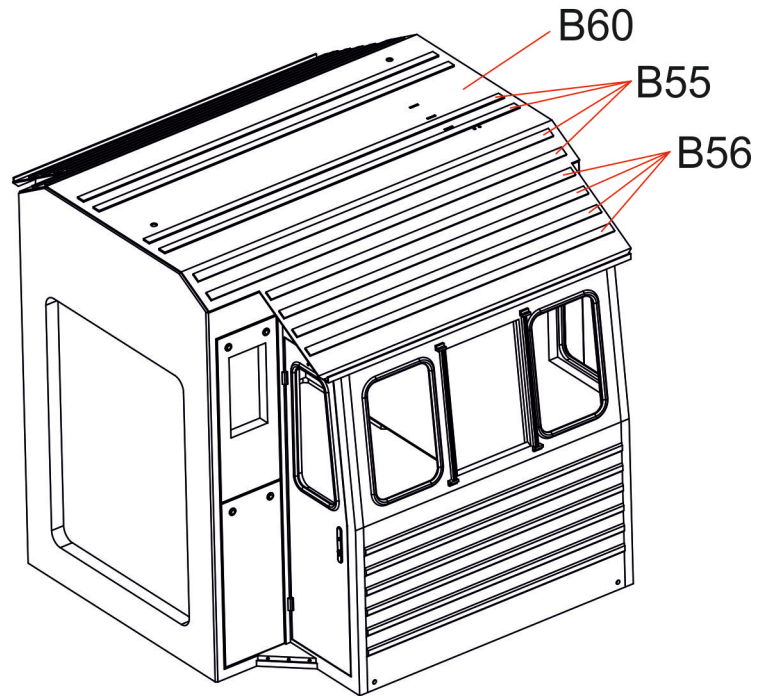
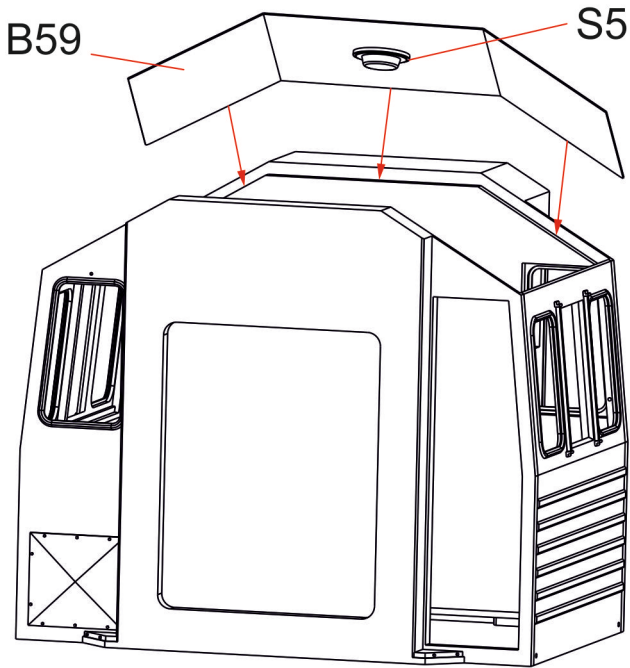
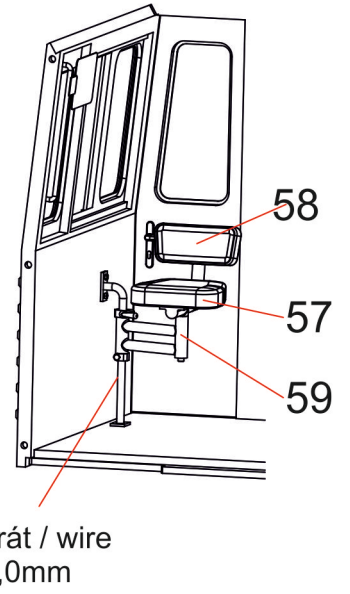

z obou stran / make on both sides

- * u těchto hran může vzniknout mezera, která do velikosti 0,5mm nevadí, bude zakryta dalším dílem
- * / a space may appear at these edges which is not a problem up to 0,5mm, it will be covered by the next piece

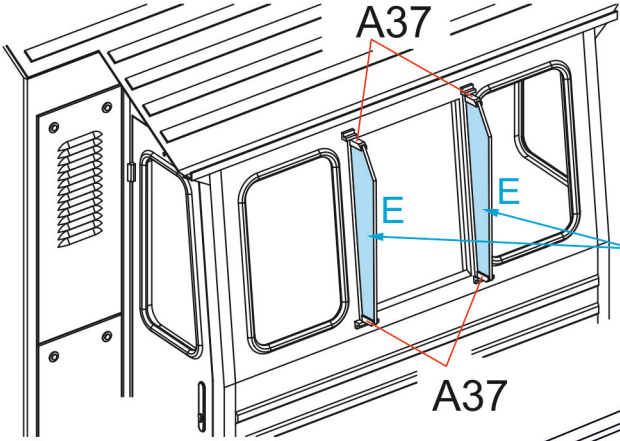

vlepit okna / place windows

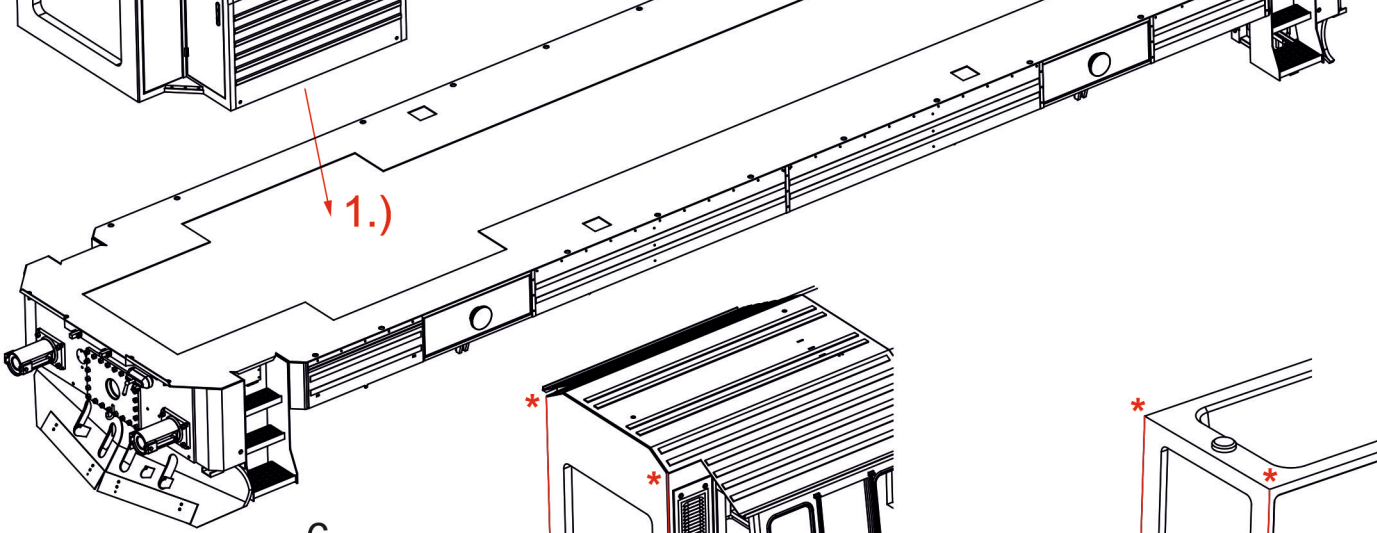
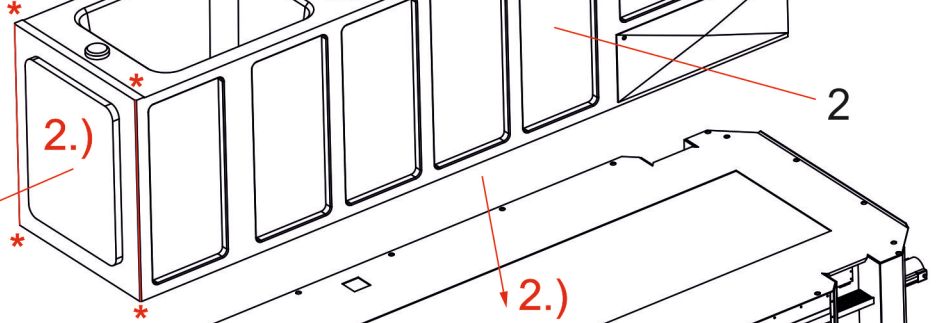
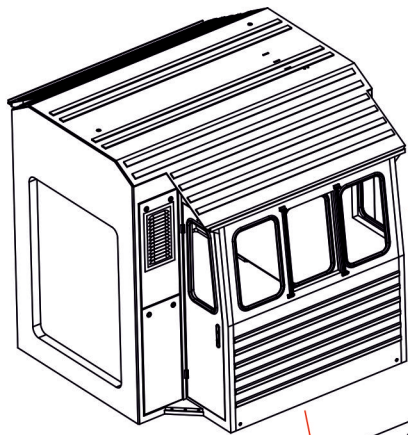

? verze / optional

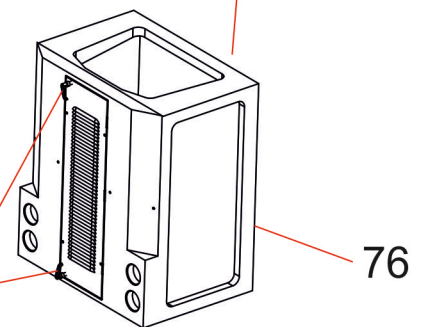
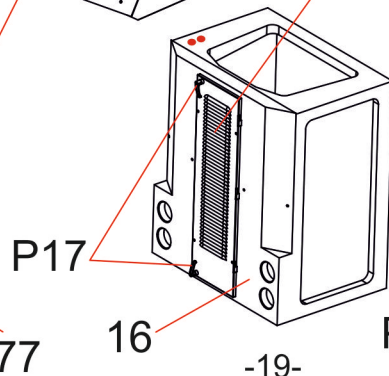
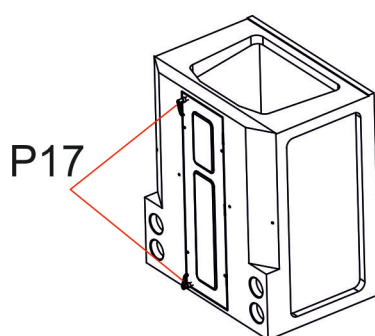
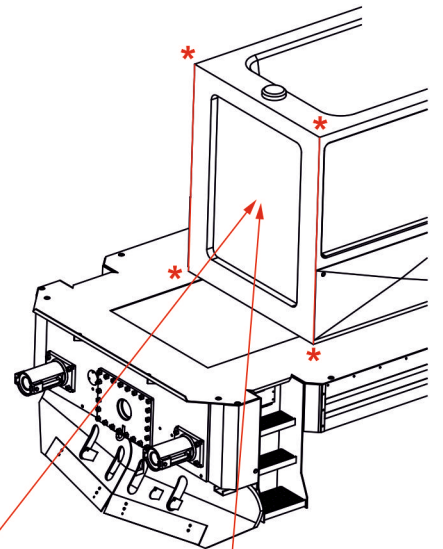
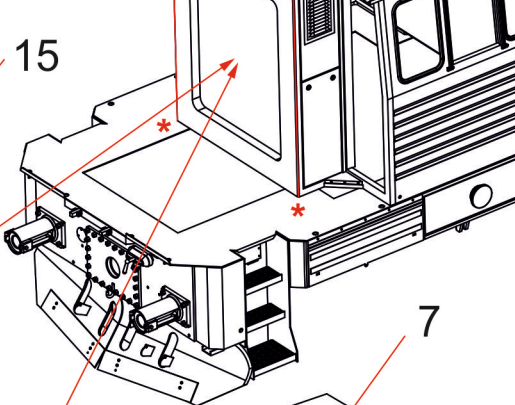
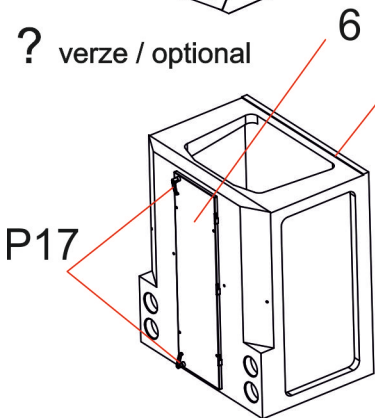

? verze / optional 1.) stará verze / old version

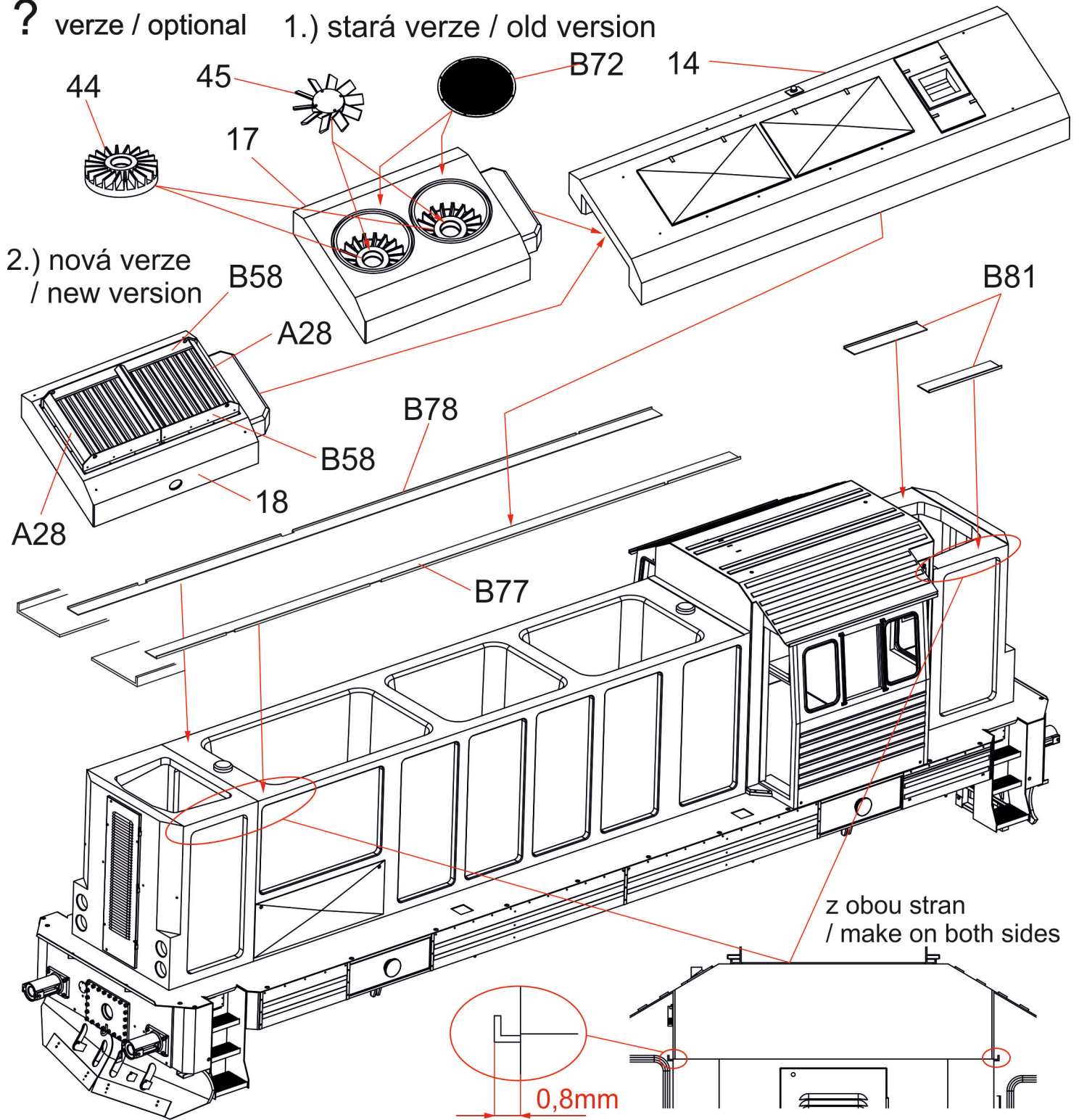

? verze / optional

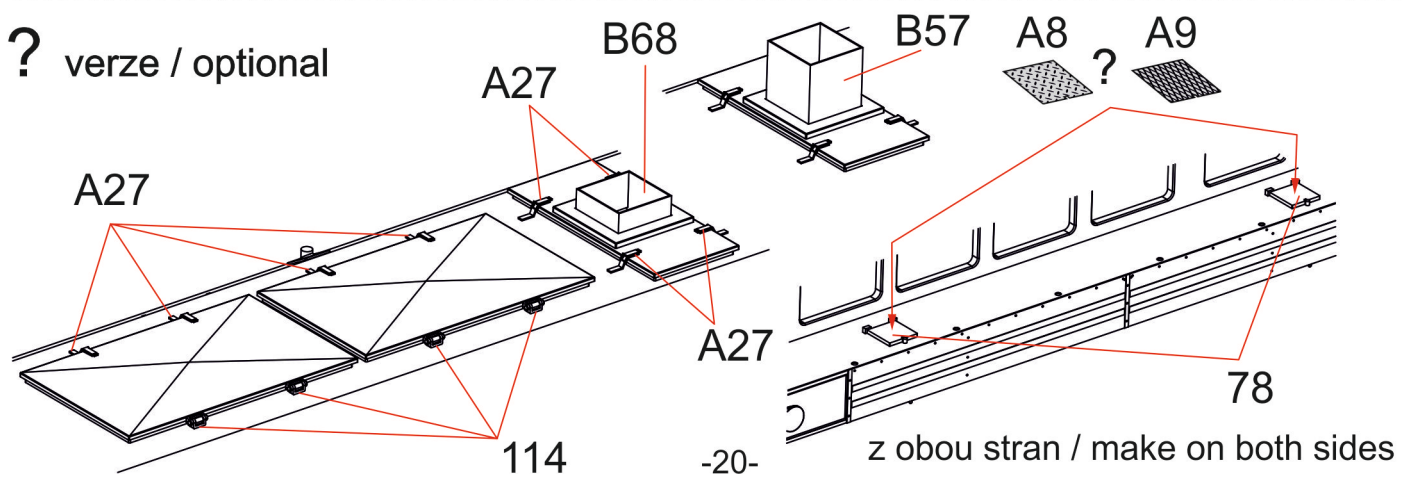

? verze / optional

1.) velký halogenový světlomet
/ big halogen lamp

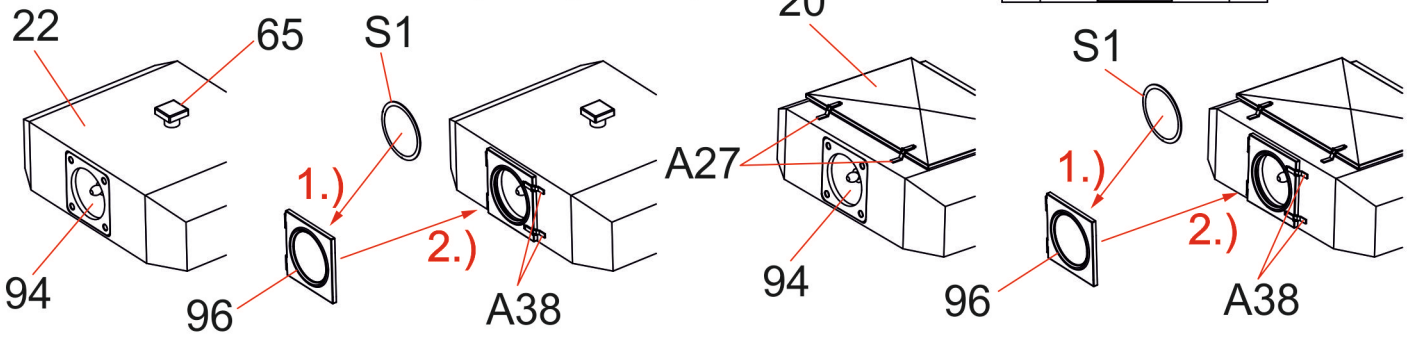

2.) světlomet se třemi světly / lamp with three lights

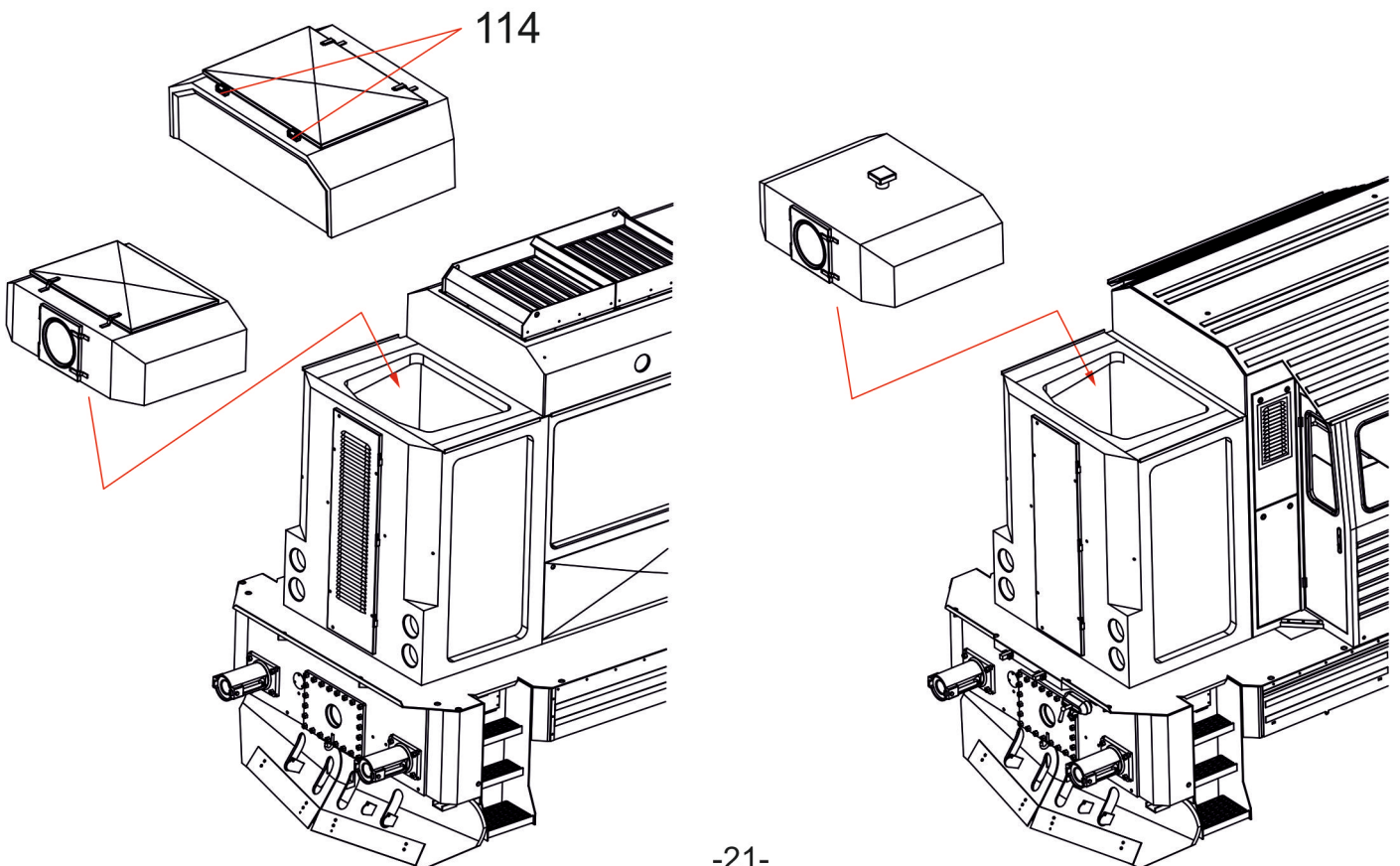
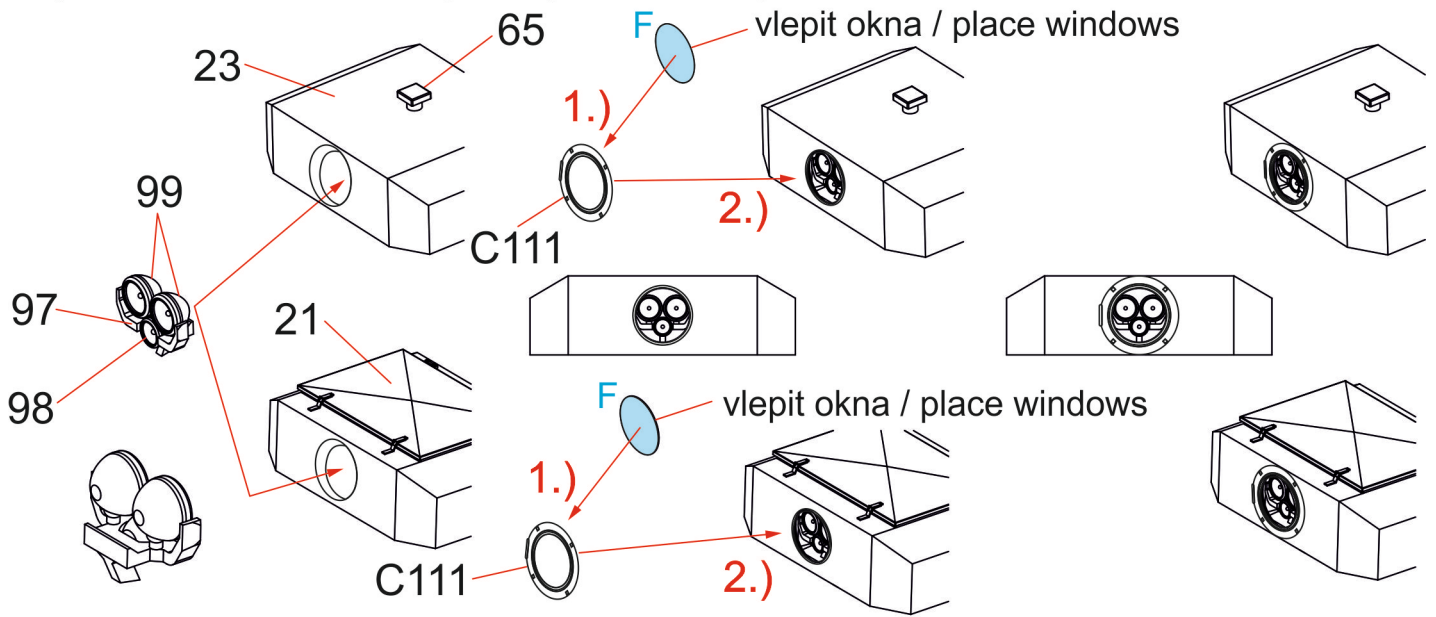

? verze / optional

použijte pouze kombinaci 2x A , 2x B nebo 1x C+ 1x D
/ use only 2x A , 2x B or 1x C+1x D combination

žaluzie uzavřené A / shutters closed A

žaluzie otevřené B / shutters opened - B

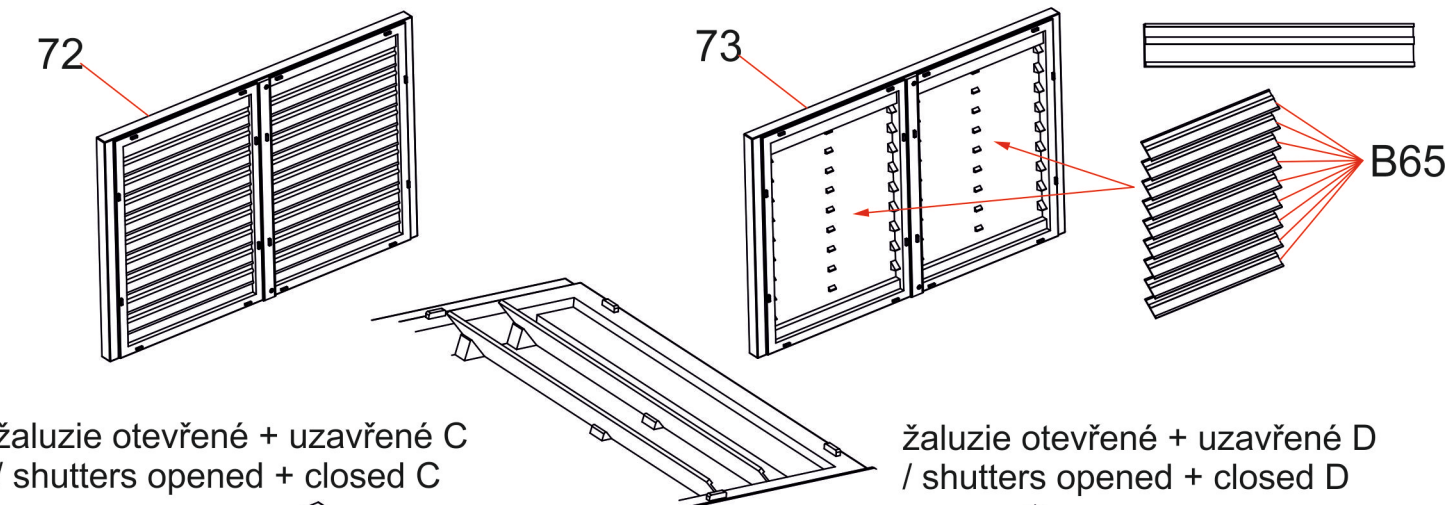

žaluzie otevřené + uzavřené C
/ shutters opened + closed C

žaluzie otevřené + uzavřené D
/ shutters opened + closed D

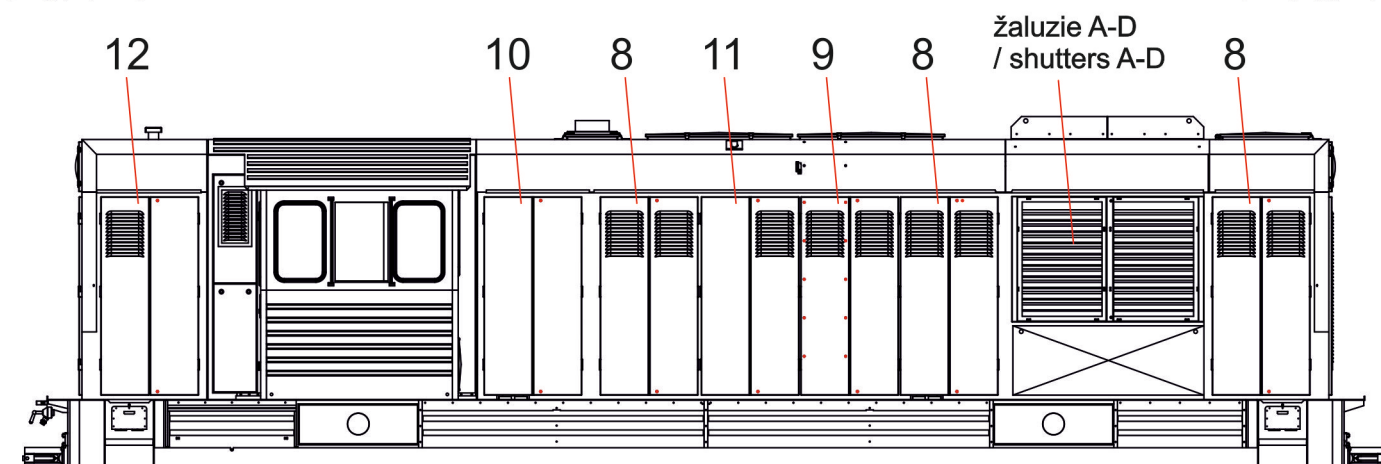
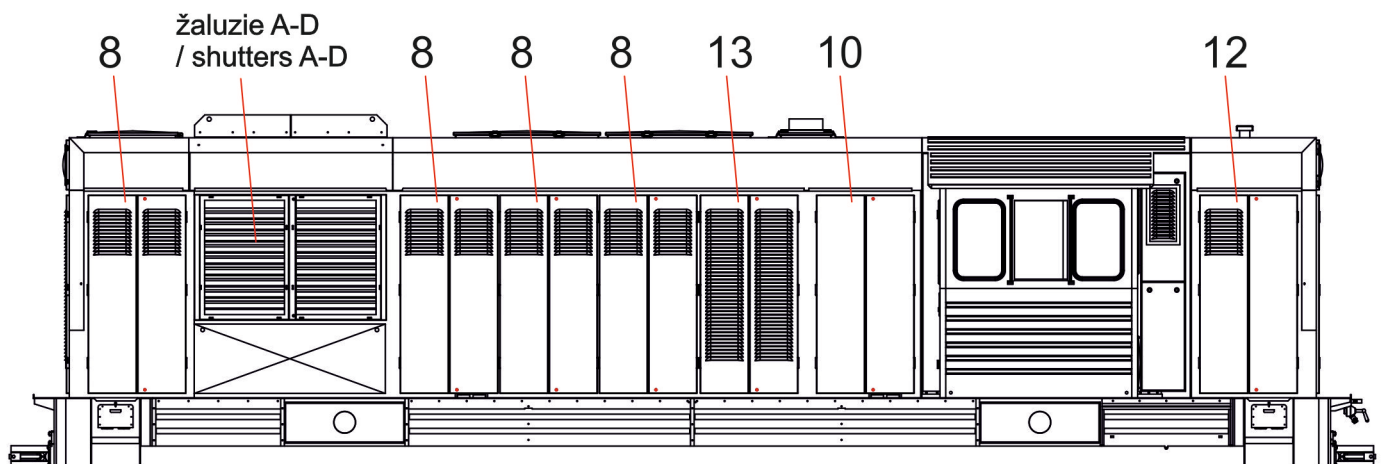
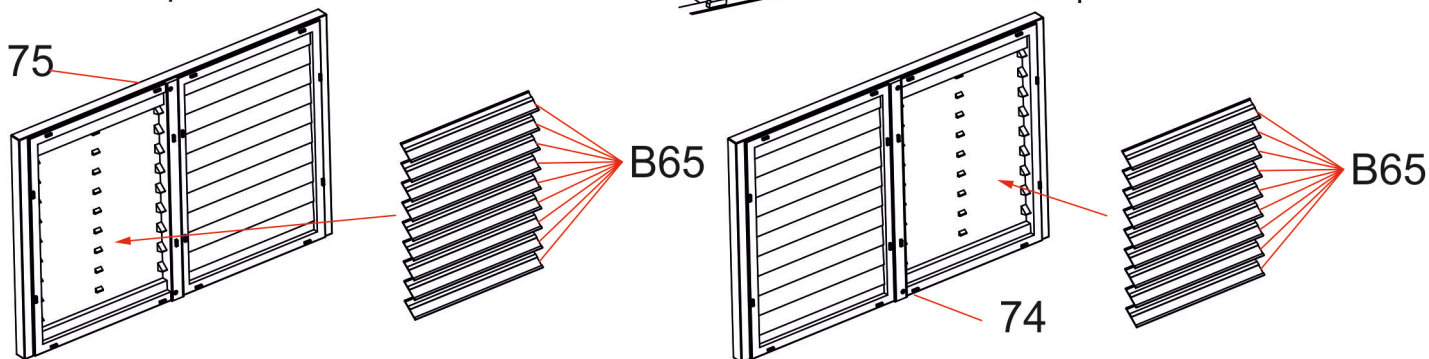

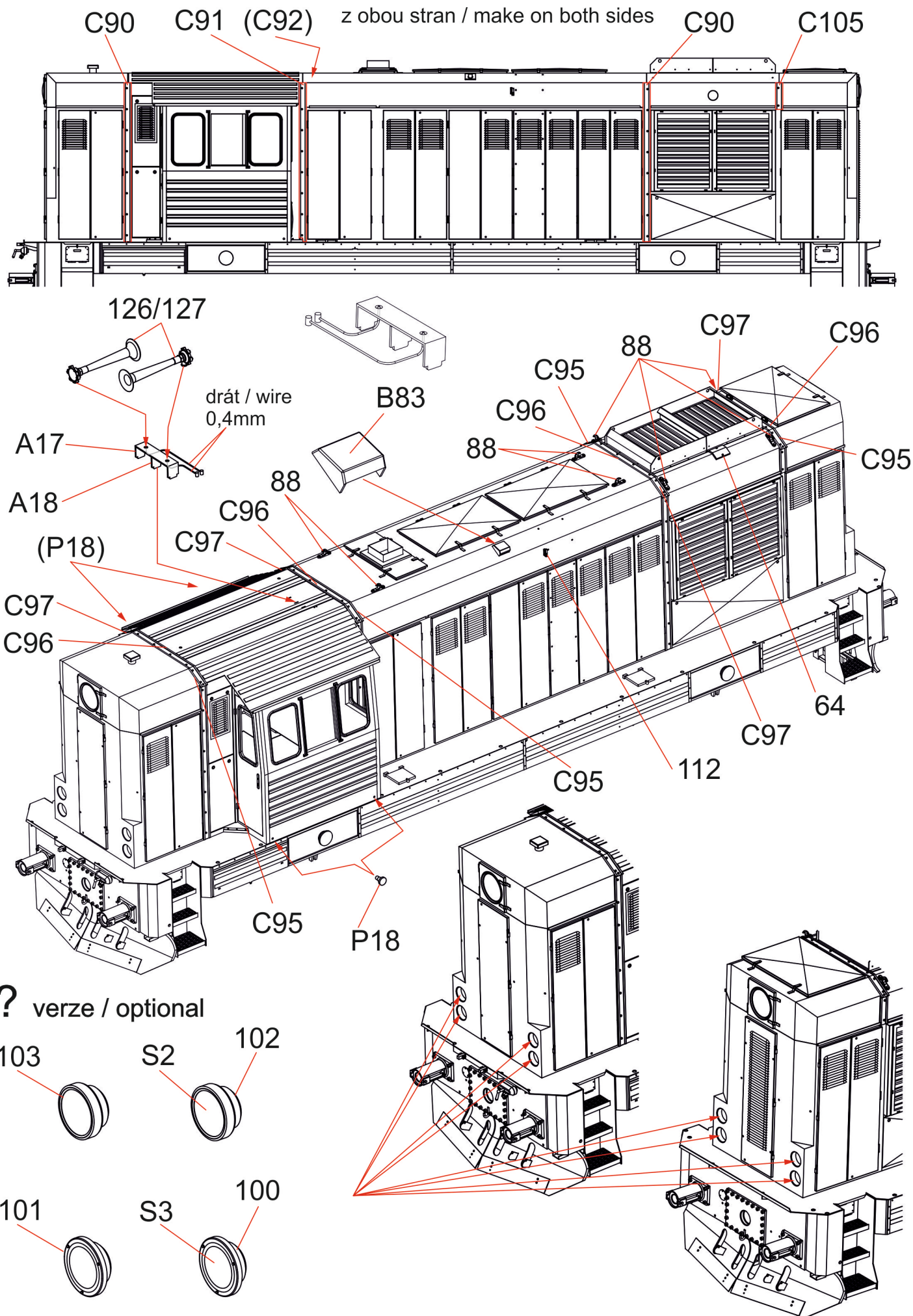

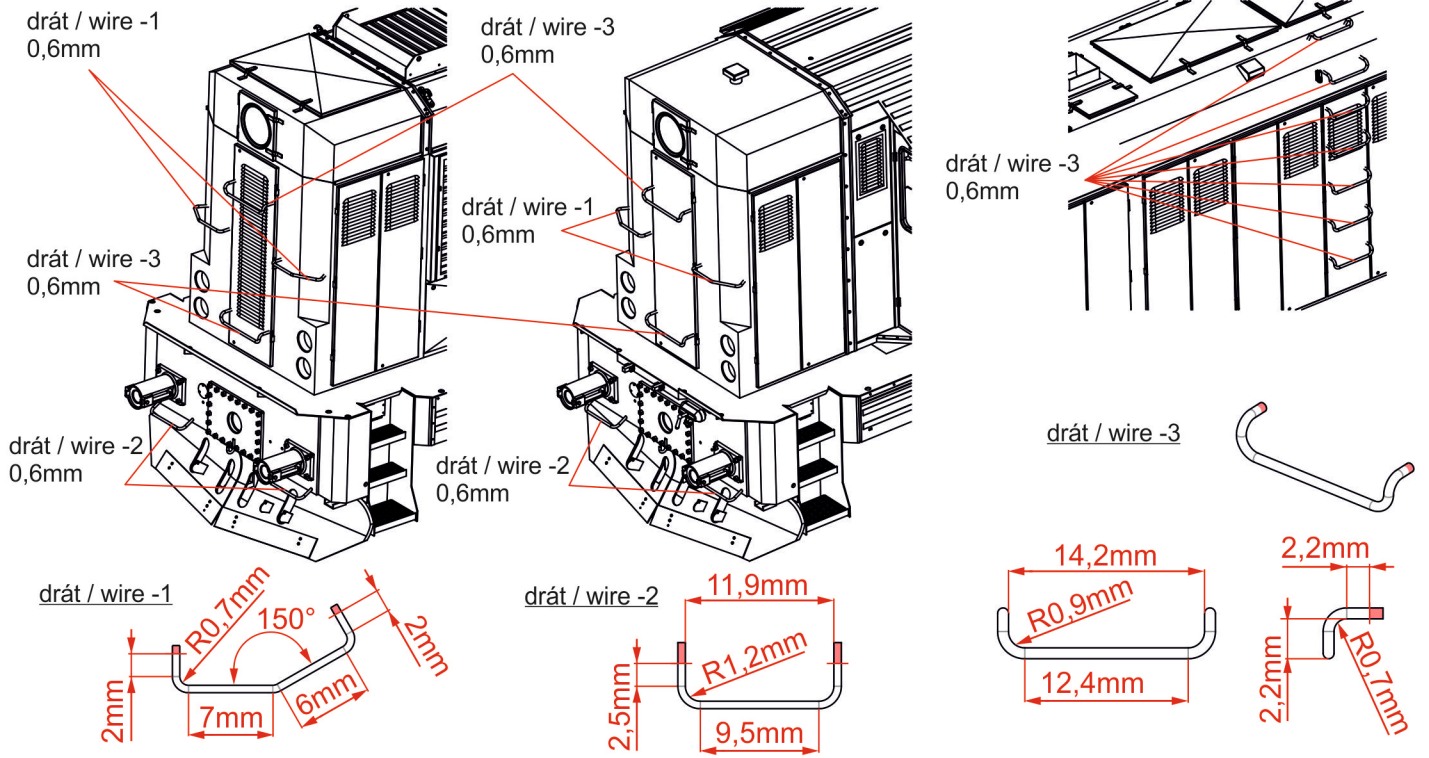

z obou stran / make on both sides P17 P17 P17 P17

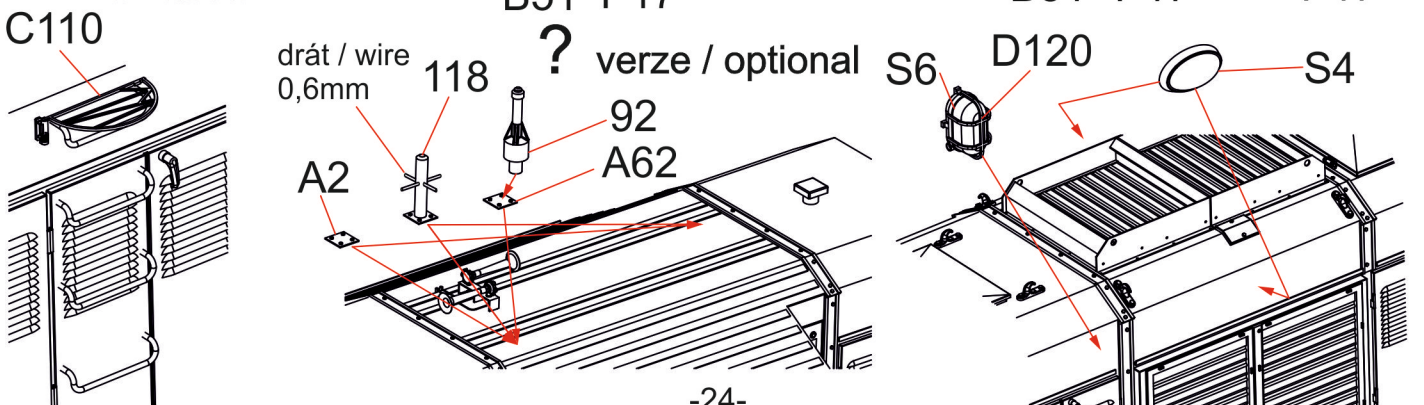
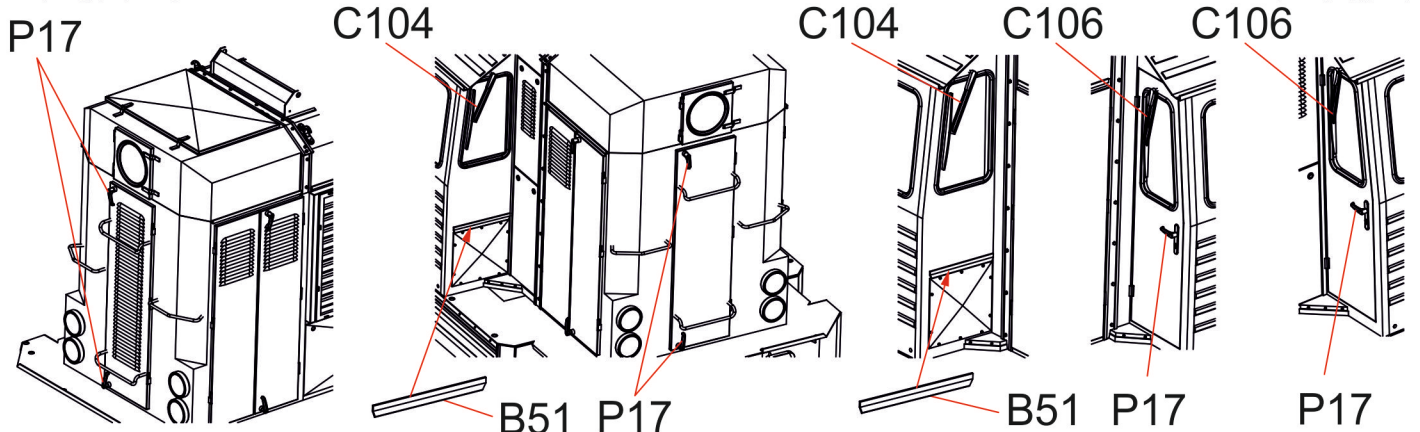
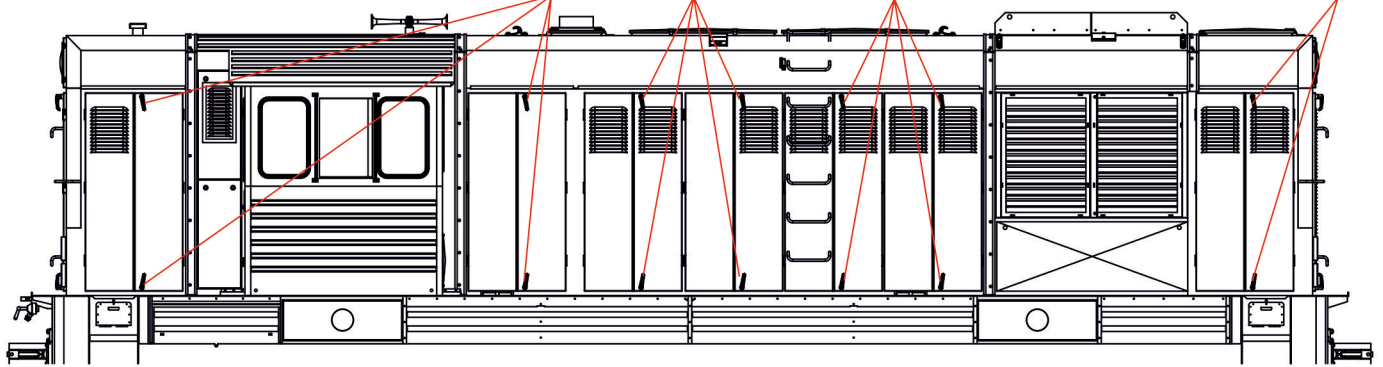

alternativa - drát
/ alternative - wire
1,2mm

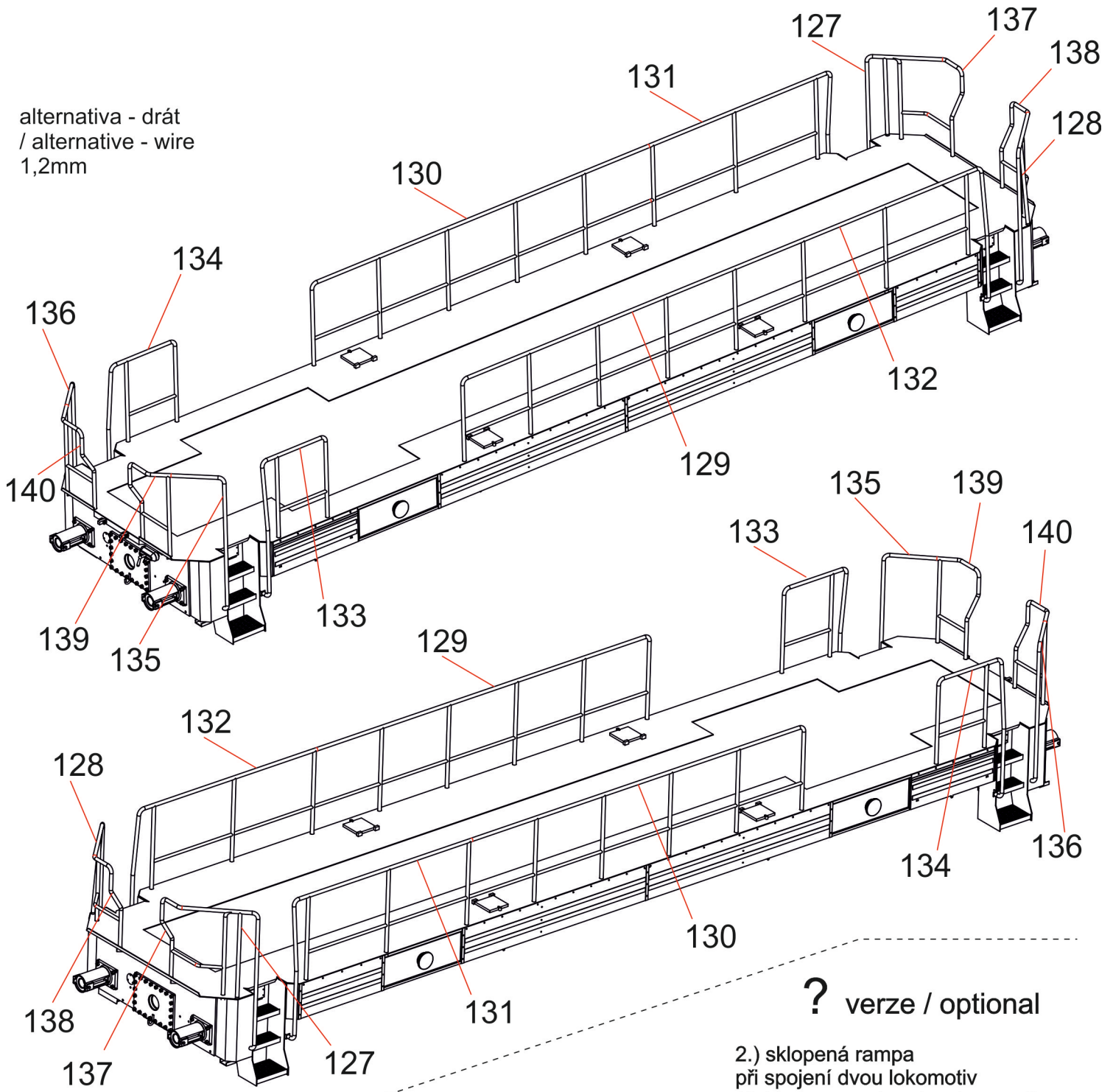

? verze / optional

2.) sklopená rampa
při spojení dvou lokomotiv
/ folded ramp when two locomotives
are connected

1.) samostatná lokomotiva
single locomotive

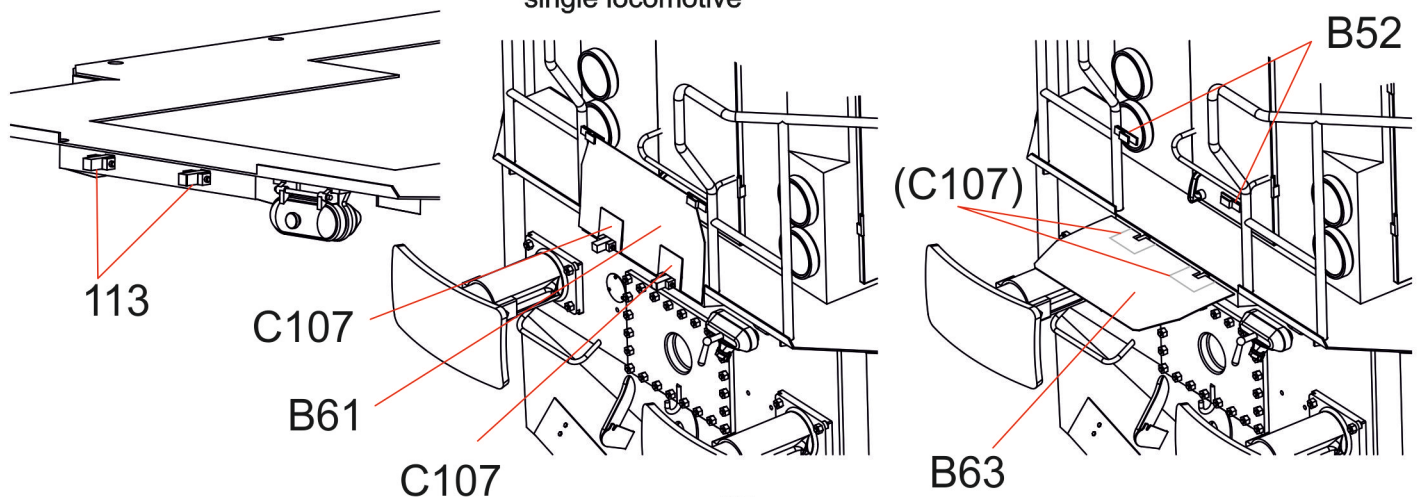

1.) samostatná lokomotiva (strana bez zapojení)
 single locomotive (side not connected)

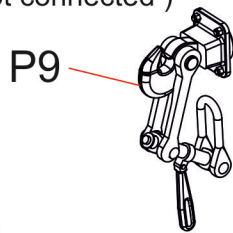

2.) spojení dvou lokomotiv
 connection of a pair of locomotives

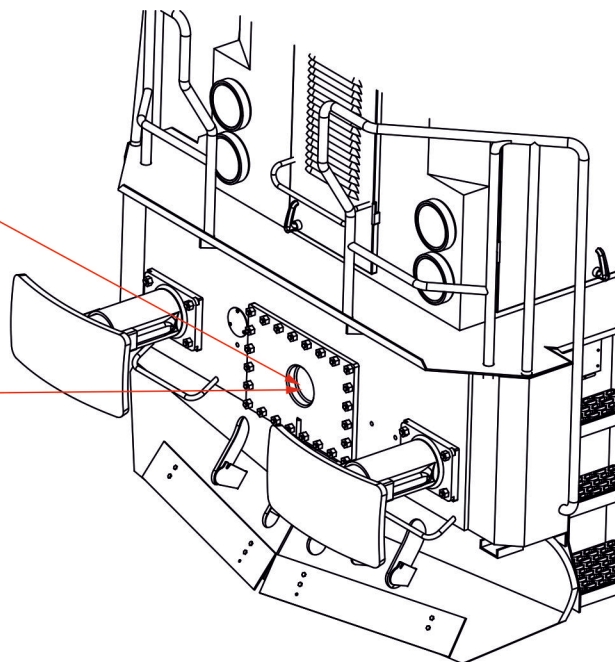
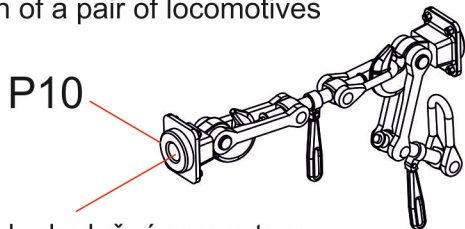

* - díl zezadu doplněný magnetem
 lze použít pro odjímatelné spojení
 (pozor na polaritu magnetů s dílem 126)
 / part with rear placed magnet
 can be used for removable connection
 (pay attention to the polarity of the magnet with 126 part)

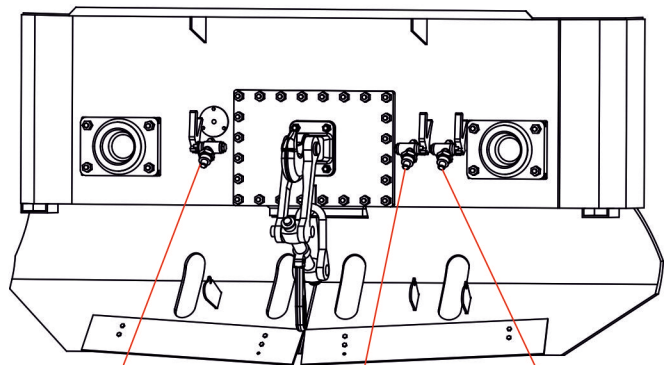

P16 P15 P15

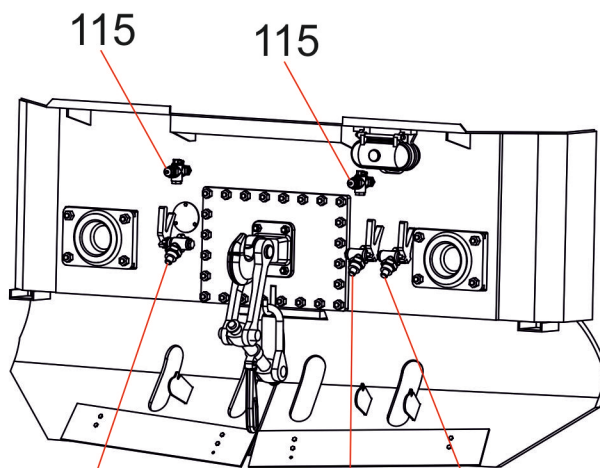

115 115
 P16 P15 P15

z obou stran / make on both sides

1.) samostatná lokomotiva (strana bez zapojení)
 single locomotive (side not connected)

2.) spojení dvou lokomotiv
 connection of a pair of locomotives

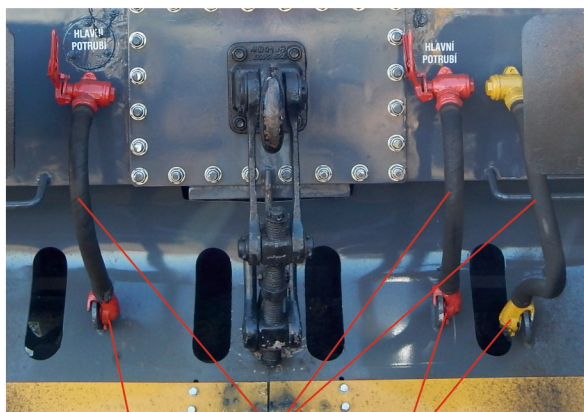

116 hadice / tube 116

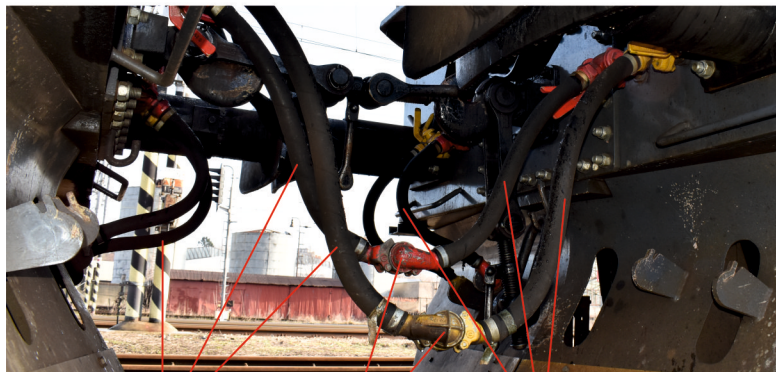

hadice / tube 117 hadice / tube

? verze / optional

individuální doplnění modelu podle fotografií / individual addition of the model according to photos

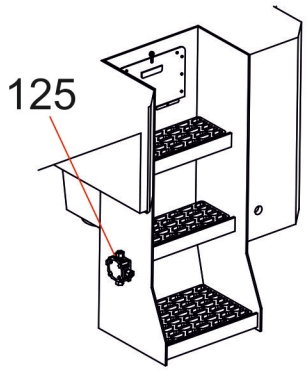

cedule - plochý nebo vystouplý text / sign - flat or raised text

D116



D116

plochý / flat - D117

vystouplý / raised - A90, D112-D115



pouze obtisk / decal only



vystouplý / raised - A90, D112-D115



B82

B71

pouze u 742 530 / only on 742 530

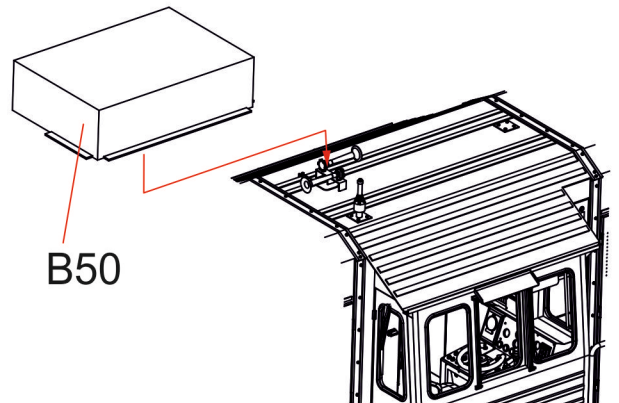

B50



B71

B82

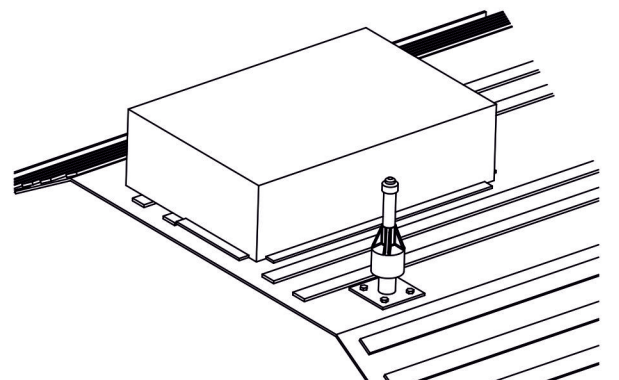

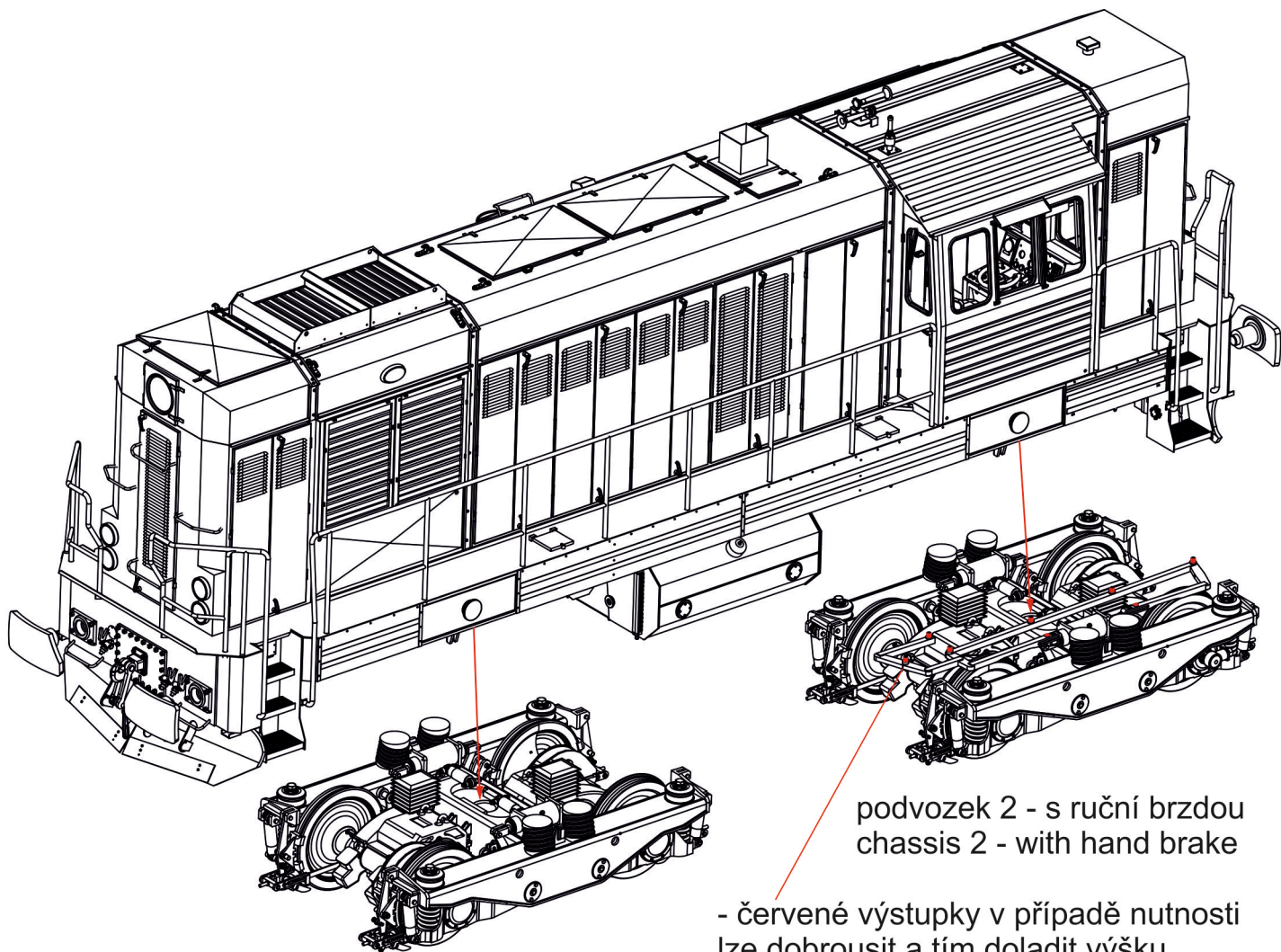

podvozek 1 - bez ruční brzdy
chassis 1 - without hand brake

podvozek 2 - s ruční brzdou
chassis 2 - with hand brake

- červené výstupky v případě nutnosti lze dobrousit a tím doladit výšku
/ - the red protrusions can be adjusted to fine-tune the height if necessary

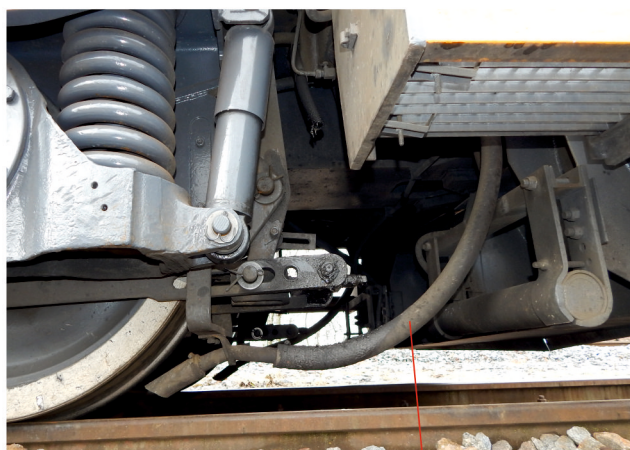

hadice / tube



hadice / tube